

01

# **SMART SOLUTIONS**

handling devices



**EUROFORK'S CATALOGUE**



experience. empower. evolve.

## CONTENTS

# EUROFORK

- 6. THE COMPANY
- 8. SWEET SPOTS

# PALLET SHUTTLE SYSTEMS

## 10. EXA PLATFORM

- 12. HIGHLIGHTS
- 14. EXA E4SHUTTLE
- 15. EXA ESMARTSHUTTLE

## 16. E4CUBE®

- 18. HIGHLIGHTS
- 20. VOLUMETRIC EFFICIENCY
- 21. TCO + RENT & LEASING
- 22. ENERGETIC EFFICIENCY AND SUSTAINABILITY
- 23. E4SHUTTLE TECHNOLOGY

## 24. E4SHUTTLE

- 26. HIGHLIGHTS
- 29. WHY E4SHUTTLE
- 30. ABSOLUTE PRECISION
- 31. GUARANTEED SAFETY
- 32. MODULARITY & FLEXIBILITY

- 34. MAXIMIZED STORAGE VOLUME
- 36. FAST CHANGE OF DIRECTION
- 37. CONDITION MONITORING

## 38. ESMARTSHUTTLE®

- 40. HIGHLIGHTS
- 42. WHY ESMARTSHUTTLE®
- 44. FLEXIBLE
- 46. ABSOLUTE POSITIONING
- 47. INDEPENDENT MISSIONS
- 49. MAXIMUM PERFORMANCE
- 50. NON-STOP WORKING
- 51. MISSION UPDATE
- 52. FUTURE-PROOF SOLUTION
- 53. SMART & PREDICTIVE MAINTENANCE
- 54. LOAD FLEXIBILITY
- 55. EASY MAINTENANCE

# TELESCOPIC FORKS

## 56. E-SMARTFORKS

- 58. HIGHLIGHTS
- 60. WORKING ENVIRONMENT MONITORING
- 61. HIGH-PERFORMANCE INDICATORS
- 62. PREDICTIVE MAINTENANCE
- 63. DOWNTIME RISK MITIGATION
- 64. MACHINE LEARNING
- 65. CLOUD BIG DATA

## 66. TELESCOPIC FORKS

- 68. HIGHLIGHTS
- 70. PALLET
- 72. AUTOMOTIVE
- 74. COILS
- 76. BOXES
- 78. ADDITIONS
- 80. SPECIAL APPLICATIONS

# AFTER-SALES

- 82. INTRODUCTION
- 84. REPAIRS & SPARE PARTS
- 85. TRAINING & MANUALS
- 86. ON-SITE & REMOTE ASSISTANCE
- 88. RETROFITTING & REVAMPING
- 89. MAINTENANCE
- 90. LOCATIONS



**26**  
YEARS OF EXPERIENCE

**+93**  
COUNTRIES USE EUROFORK DEVICES

**+130.000**  
APPLICATIONS WORLDWIDE

Eurofork was founded in 2000 in the northwest part of Italy, close to Turin, with the ambition of becoming a world leader in the production of automatic handling systems for automated warehouses.

Today the company is a reference point for the world's leading system integrators, recognized as one of the leaders in the production of high-end handling devices in the intra-logistic sector.

One of Eurofork's success reasons is the decision to adopt a Made in Italy policy and to equip all products with components from the best worldwide brands. The entire Group strives to continually evolve, promoting technological transfer to new sectors and opportunities.

**PHILOSOPHY**

Always looking to the future, to propose innovative solutions in the field of automatic handling, anticipating change.

Eurofork aims to become a world-class innovation hub, putting people at the centre of the project and always investing in new businesses, with particular attention to social and environmental sustainability.

# SWEET SPOTS

Today, with its wide product range composed of telescopic forks, ESMARTSHUTTLE® and E4SHUTTLE, Eurofork covers any handling requirement in the automated warehouse.

8

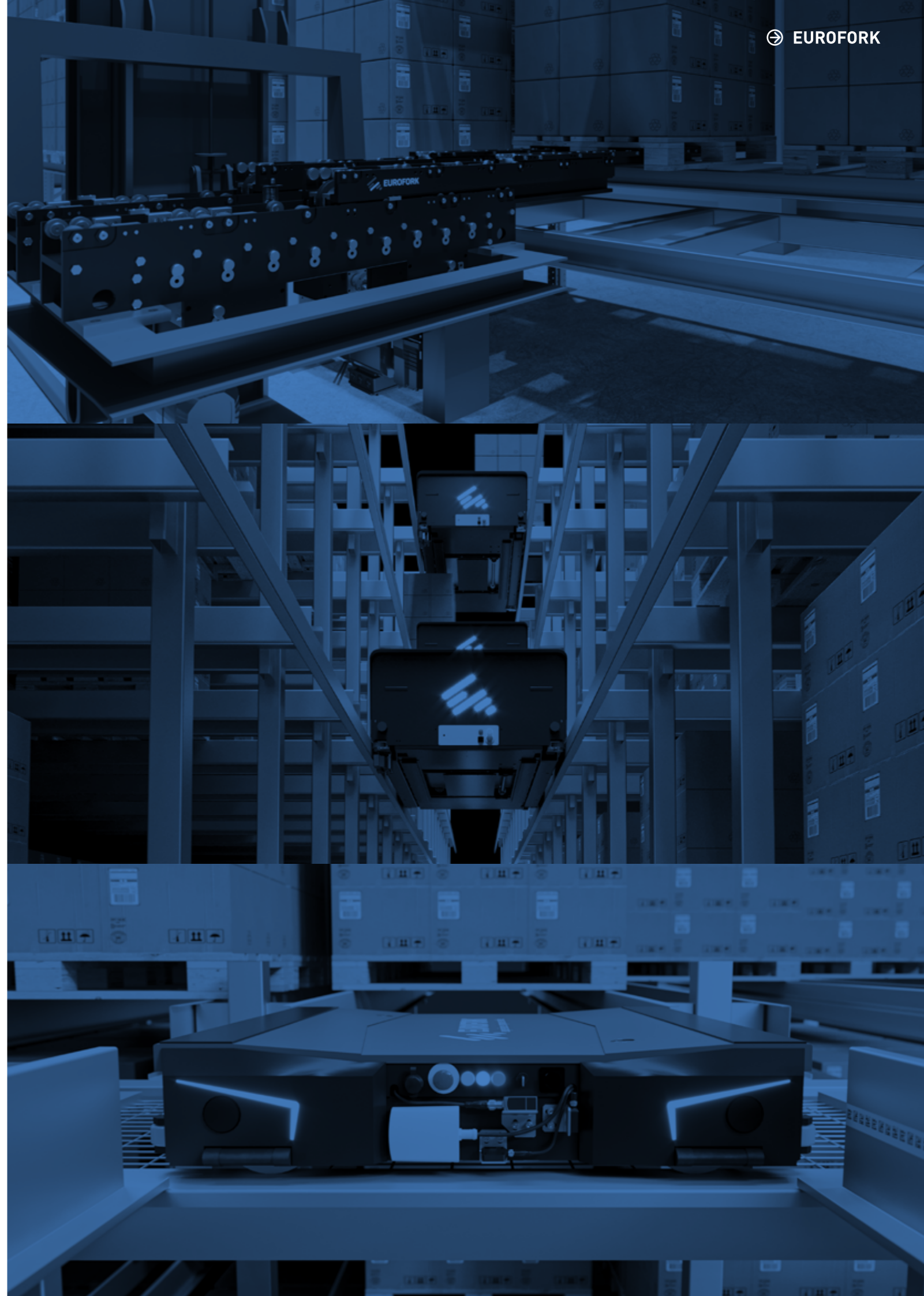
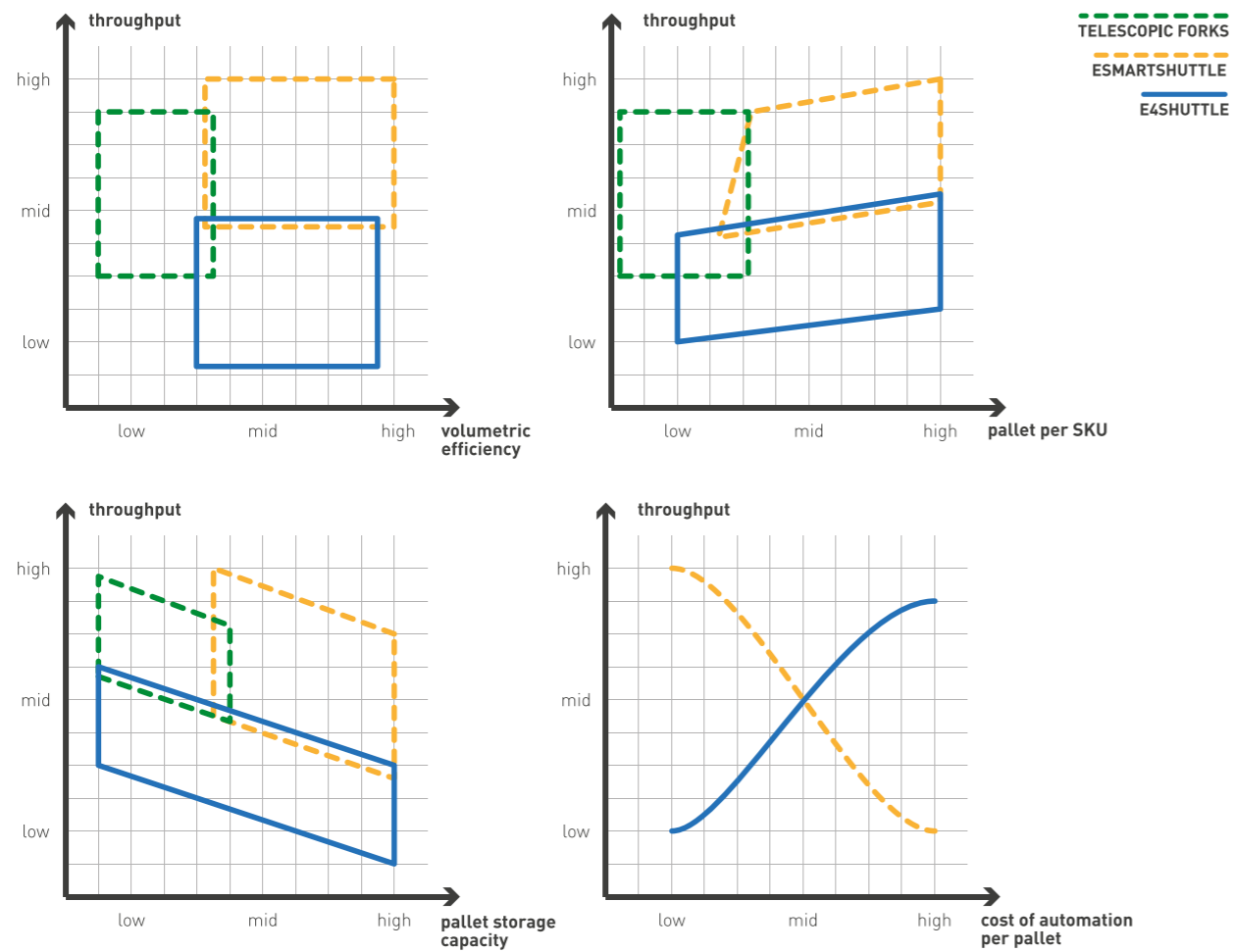

# EXA PLATFORM

10

Undoubtedly, software and artificial intelligence stand as the cornerstone of the future. Recognizing this, Eurofork has seamlessly integrated a pioneering entity in the intralogistics software sector, positioned to actualize the products of tomorrow, today!

Leading the way in innovation, Eurofork's technological software hub functions as a central point for advanced solutions. The customer can now benefit from a comprehensive 'turnkey' package encompassing consultancy, analysis, commissioning, testing, training, and round-the-clock assistance, all meticulously provided by the dynamic Eurofork software team.

Eurofork's technological software hub developed a software platform to address the need for optimizing and efficiently managing automated warehouses. EXA is the new advanced software platform tailored to manage pallet shuttle systems, including the sophisticated E4SHUTTLE and ESMARTSHUTTLE®. Offering intuitive controls and robust features, thanks to AI technology, EXA redefines warehouse management, providing unparalleled control and optimization for seamless operations.

11

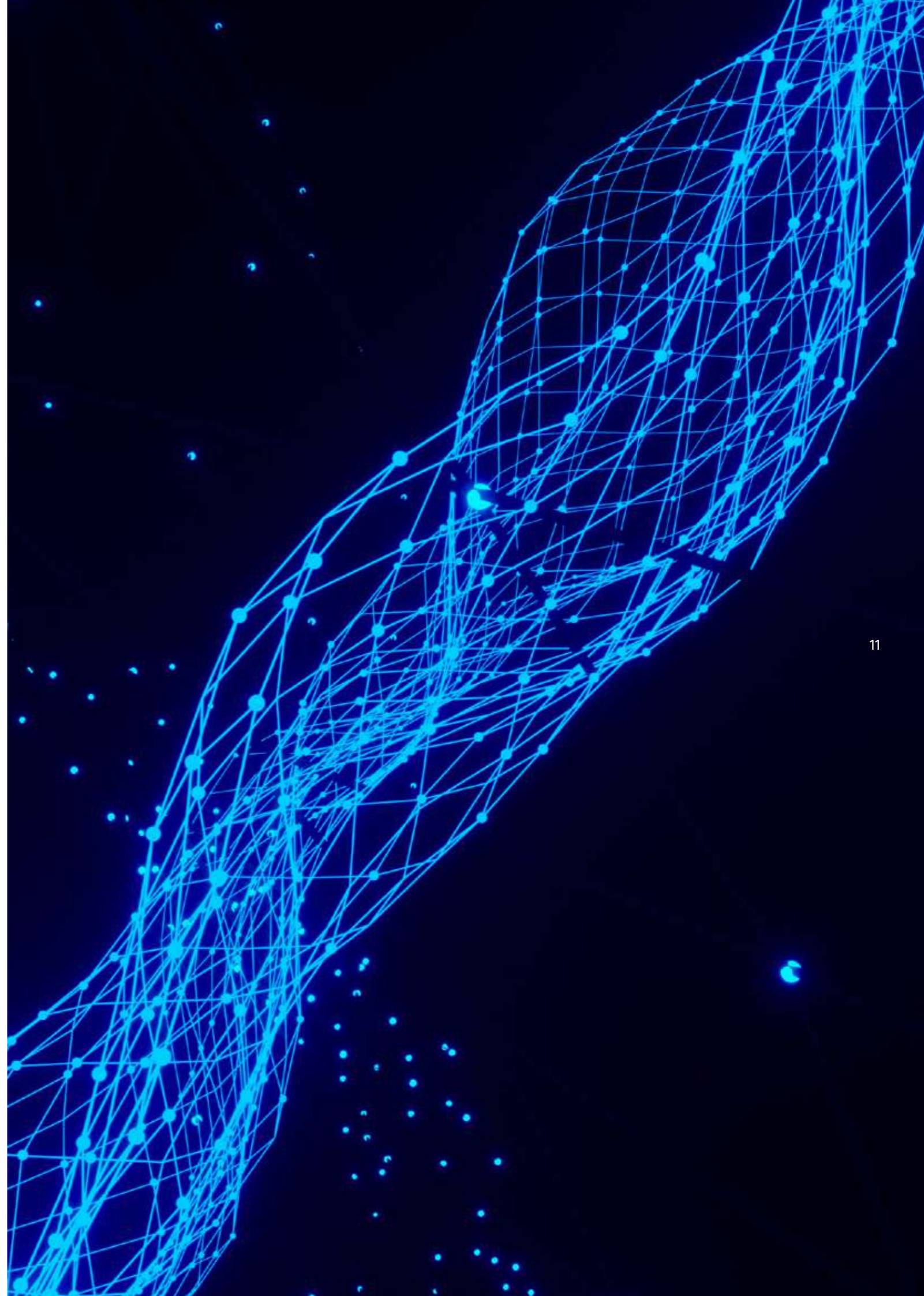

# EXA HIGHLIGHTS



## DATAMATRIX INTEGRATED MANAGEMENT

The Datamatrix solution serves as the GPS (Global Positioning System) for all Eurofork machines



## WEB BASED APPLICATION

All functionalities are readily accessible through any browser. No software installation is required to utilize the complete Eurofork software solution (EXA)



## NEW HMI

The multiplatform HMI allows direct usage on various devices such as PC, Mac, browser, and mobile devices (via app)



## OPC-UA TECHNOLOGY

Flexibility to interface with any PLC brands

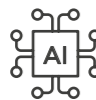

## AI

Intelligent Routing Management for ESMARTSHUTTLE® and E4SHUTTLE, dynamically managing traffic based on ever-changing conditions



## PREDICTIVE MAINTENANCE

Big Data and continuous machine communication achieve the maintenance optimization and avoid unexpected downtime



## DIGITAL TWIN

Simulation and modelization of our system achieve high performance and increase the commissioning efficiency



## REAL-TIME NOTIFICATION SYSTEM

Customized interface with real-time maintenance update



# EXA E4SHUTTLE

14

PLUS

**SMART**

**LITE**

- Machine safety
- Bounded traffic management
- Mission time guarantee
- Warehouse mapping
- AI ready
- Interaction with WMS
- Battery management and maintenance

- Advanced traffic management
- Dynamic E4SHUTTLE roaming
- Multiple missions performance guarantee
- Multiple E4SHUTTLE per level management
- Pallet lifters management

- Pallet location management
- AI algorithm integration
- System performance guarantee
- Interaction with ERP/WMS
- HMI and handling management
- Pick ticket management

# EXA ESMARTSHUTTLE

15

PLUS

**LITE**

- Machine safety
- Traffic management
- Mission time guarantee
- Warehouse mapping
- AI ready
- Interaction with WMS
- Battery management and maintenance

- Pallet location management
- AI algorithm integration
- System performance guarantee
- Interaction with ERP/WMS
- HMI and handling management
- Pick ticket management

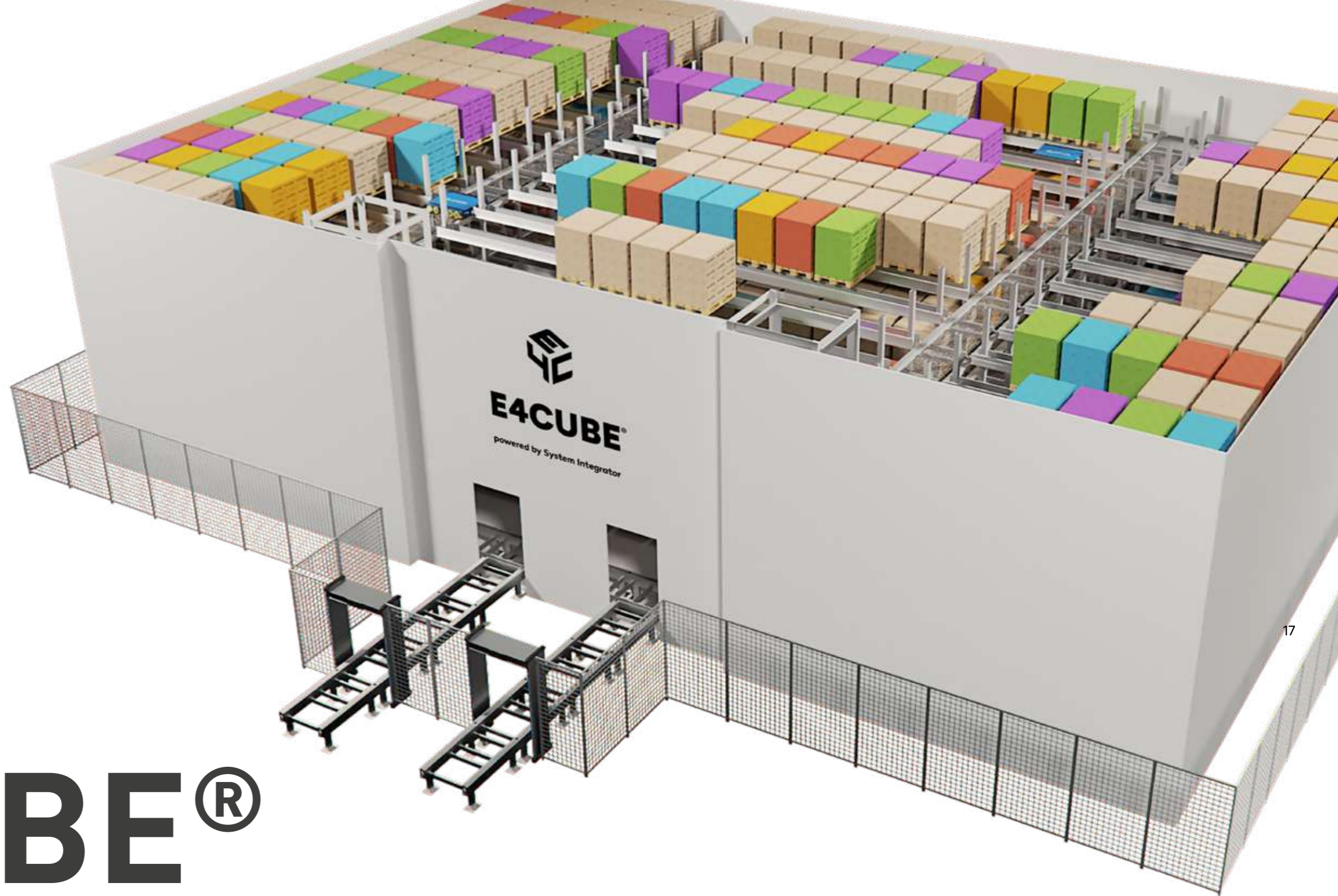

# E4CUBE®

Companies frequently rely on system integrators for pallet handling solutions that are standardized, flexible, future-ready, and sustainable. In partnership with system integrators, we designed E4CUBE® by Eurofork—a groundbreaking approach to automated pallet storage that combines standardization with exceptional flexibility.

E4CUBE® is a highly adaptable, plug-and-play warehouse system. It offers a wide array of modular and standardized configurations to precisely meet system integrators' needs. With its unrivalled flexibility and fast deployment, E4CUBE® can easily fit into existing spaces and become fully operational within just six months—from order placement to Go Live.

# HIGHLIGHTS



## THE LOWEST TCO

Compared to alternative automation solutions with equivalent performance



## REGISTERED INDUSTRIAL DESIGN

Eurofork exclusive property



## GLOBAL PATENTS

Absolute positioning and item traceability



## ENERGY SAVING

up to 80% lower energy consumption

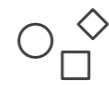

## FLEXIBILITY

Available in thousands of standard versions



## FASTER ROI

Compared to other automation solutions



## SCALABILITY

Easily scalable to meet the needs of tomorrow



## LEAD TIME

Go-live in 6 months



## SUSTAINABILITY

Certified CO2 offset solution



## VOLUMETRIC EFFICIENCY

Best-in-class storage density



## HIGH PERFORMANCE

Turnover rate up to 735/year



## EXA

Powered by EXA platform



## ONLINE CONFIGURATION

Configurable with just a few clicks



## SOLUTION-AS-A-SERVICE

100% leasable or financeable without upfront investment





20

# VOLUMETRIC EFFICIENCY

E4CUBE® offers an unmatched solution in storage density, maximizing available space. Its innovative design optimizes every millimetre, enabling efficient resource management. Developed to meet advanced storage demands, E4CUBE® stands out for its adaptability across various contexts, making it an ideal choice for those seeking high performance without sacrificing versatility.

# TCO + RENT & LEASING

E4CUBE® ensures an up to 55% reduction in total cost of ownership (TCO), providing highly efficient financial management. It is also available through leasing options (operational or financial) with no upfront payment, enabling immediate access. This approach significantly lessens the impact on cash flow compared to traditional solutions, improves long-term operating costs, and delivers an excellent return on invested capital (ROIC).



21

# ENERGETIC EFFICIENCY AND SUSTAINABILITY

Thanks to the reduced volume and weight of the E4SHUTTLE pallet shuttles that handle the load units, E4CUBE® delivers exceptional energy efficiency, reducing consumption by up to 80% compared to traditional solutions. Consequently, this system emits significantly less CO<sub>2</sub> than other warehouse automation solutions. E4CUBE®'s carbon emissions are offset through Carbon Credit purchases, making it the greenest automation solution on the market.

22



23

## E4SHUTTLE TECHNOLOGY

At the heart of E4CUBE® is our advanced four-way pallet shuttle, the E4SHUTTLE, fully integrated into the warehouse structure. Developed based on the 40 million kilometres travelled by our ESMARTSHUTTLE®, the E4SHUTTLE incorporates internationally patented technologies such as absolute positioning and blockchain-based traceability. These innovations provide outstanding and top-level performance, ensuring highly efficient and reliable warehouse management.

# E4SHUTTLE

E4SHUTTLE is the new multi-level and multi-depth four-way shuttle designed by Eurofork for all the automatic warehouses that need high-density storage.

Thanks to its flexibility and high-quality performances, the E4SHUTTLE is the ideal solution to increase storage capacity and boost warehouse throughputs.

E4SHUTTLE combines all the most relevant advantages of ESMARTSHUTTLE® such as absolute positioning, great flexibility and massive performance into an innovative solution that makes its patented features its unquestionable added value.

The experience gained over more than 10 years by the ESMARTSHUTTLE®, with 44 million kilometres travelled (more than 1.000 globe turns!) and 4,4 trillion QR codes of DataMatrix scanned, makes Eurofork's pallet shuttle systems a market-proven and future-proof solution.





# HIGHLIGHTS

 **ABSOLUTE POSITIONING** PATENTED  
Absolute certainty of shuttle and loads' position

 **ITEM TRACEABILITY** PATENTED  
Possibility to trace back every shuttle and load's movement

 **GUARANTEED SAFETY** PATENTED  
Patented system to safely access the warehouse

 **VOLUME OPTIMIZATION**  
Maximized pallets stored, regardless of their size

 **GREAT SCALABILITY**  
Flexible increase/removal of shuttles according to business needs

 **BORN FOR HIGH-DENSITY**  
Guaranteed by the experience and know-how of Eurofork

 **CONDITION MONITORING**  
AI on board and data analysis to improve efficiency

 **EXA**  
Powered by EXA platform



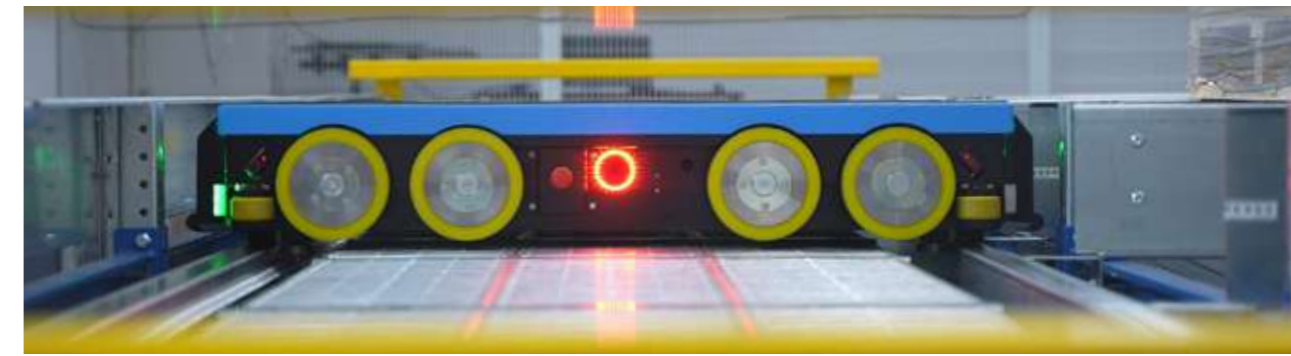

# WHY E4SHUTTLE

29

## Best Dynamics

- Absolute positioning (datamatrix international patent)
- No repositioning required
- Fast approaching speed when driving below pallet
- Machine paths can cross each other at any time
- The software decides what's the best road to reach a specific datamatrix position

## Best traffic management software

- Multiple E4SHUTTLE per main aisle and per storage lane (queuing feature)
- Aisle/level easy roaming
- Dynamic crossing aisles positions

## Flexible pallet allocation

- Different pallet types and different load overhang, possible to be stored within the same storage channel without repositioning missions
- Constant distance between consecutive loads with different size

## A.I. onboard

- Automatic system restore without any homing requirement
- Automated path recalculation in case of any need
- Continuous condition monitoring
- Real-time maintenance interval check

## Cost-effective rack design

- Freedom for any rack supplier to apply its best practices to design with no ties to a single provider (homologated rack vendors available)



# ABSOLUTE PRECISION

With its international patent, Eurofork shuttle systems are the only ones that guarantee the absolute positioning of machines and pallet destinations.

E4SHUTTLE 3D maps the entire warehouse, allowing machines to move and store goods with outstanding precision and repeatability, optimising channel space with compact pallet positioning.

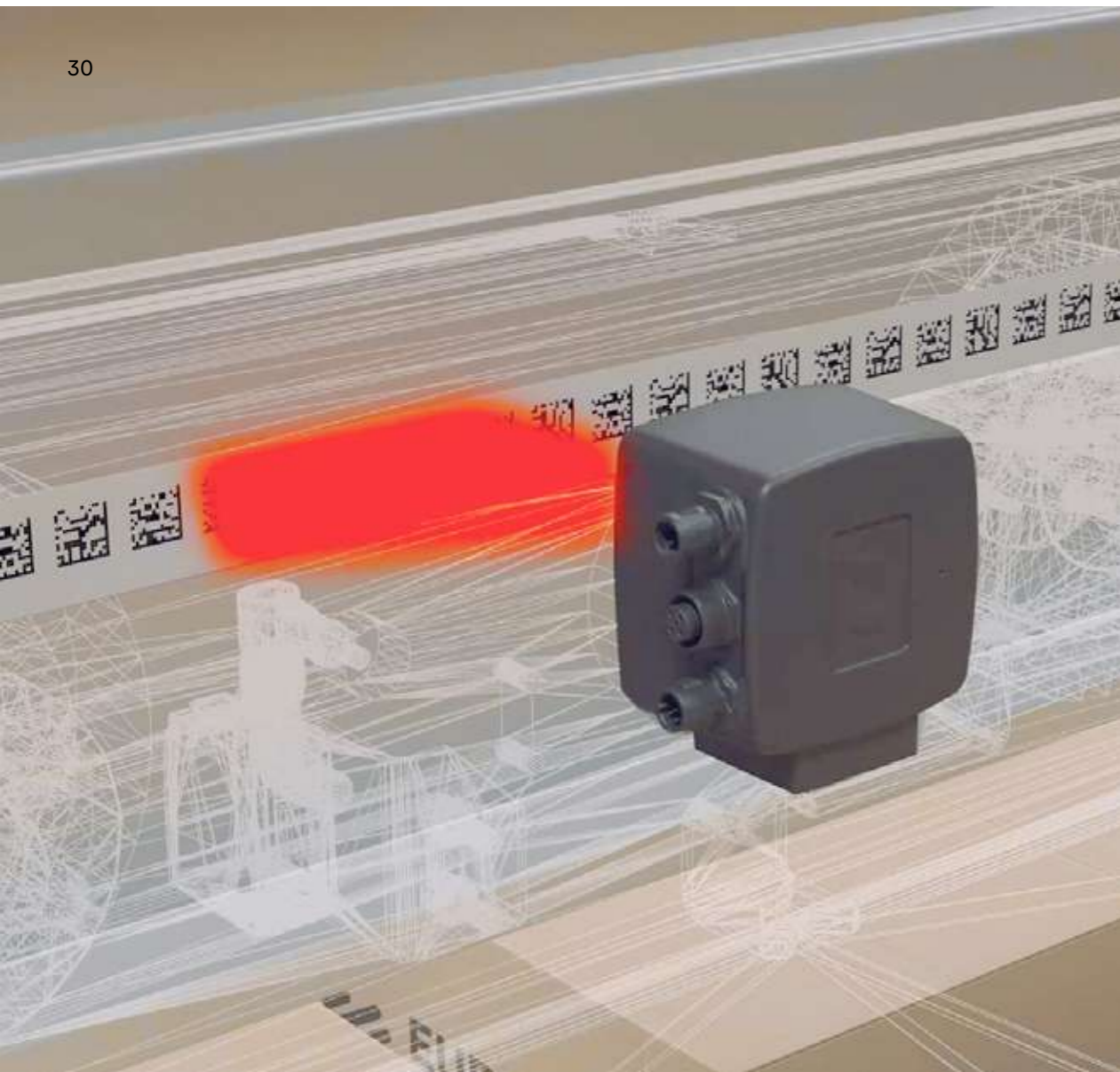

30



31

# GUARANTEED SAFETY

E4SHUTTLE, thanks to its patented system that ensures secure access to the automated warehouse, prioritizes safety, instilling confidence in every operation.

With controlled and secure entry, E4SHUTTLE sets a new standard for safety in material handling, safeguarding the well-being of both the workforce and warehouse operations.

Additionally, the main aisle catwalks are designed to minimize the risk of stumbling, further enhancing safety throughout the facility. Routine maintenance is conducted entirely outside the warehouse, reducing potential risks for personnel and ensuring a safer, interference-free work environment.

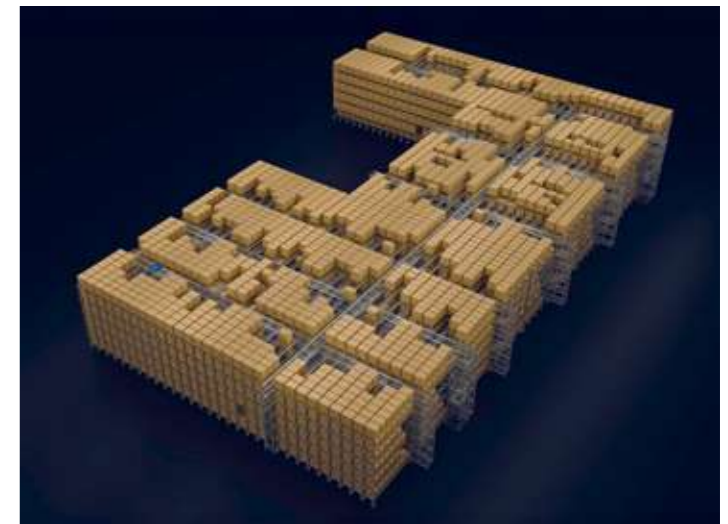
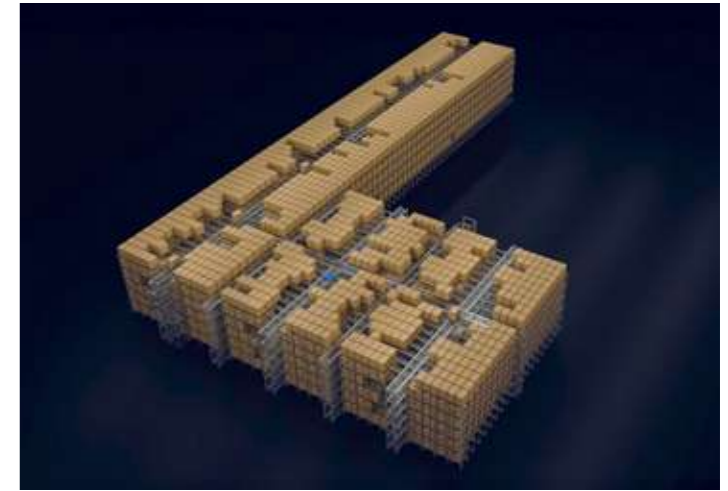

# MODULARITY & FLEXIBILITY

The four-way moving capability allows the absolute flexibility of the machine to adapt to any layout shape. In addition, it is possible to insert/remove shuttles with respect to your storage needs, optimising your investment without missing out on peak workloads.





34



35

# MAXIMIZED STORAGE VOLUME

Experience peak efficiency in automated warehousing with E4SHUTTLE. Designed for high flows and 24/7 intensity, it maximizes pallet storage volume, accommodating diverse sizes seamlessly. With unmatched reliability and dynamic optimization, E4SHUTTLE redefines warehouse efficiency, ensuring a compact, versatile, and cost-effective solution for your storage needs.



# FAST CHANGE OF DIRECTION

The E4SHUTTLE introduces a groundbreaking advancement in warehouse agility, facilitating swift changes of direction with utmost reliability. This is made possible by its cleverly designed mechanics, ensuring not only rapid but also durable wheel set change. Thanks to this feature, E4SHUTTLE guarantees best-in-class performance optimizing the throughput.

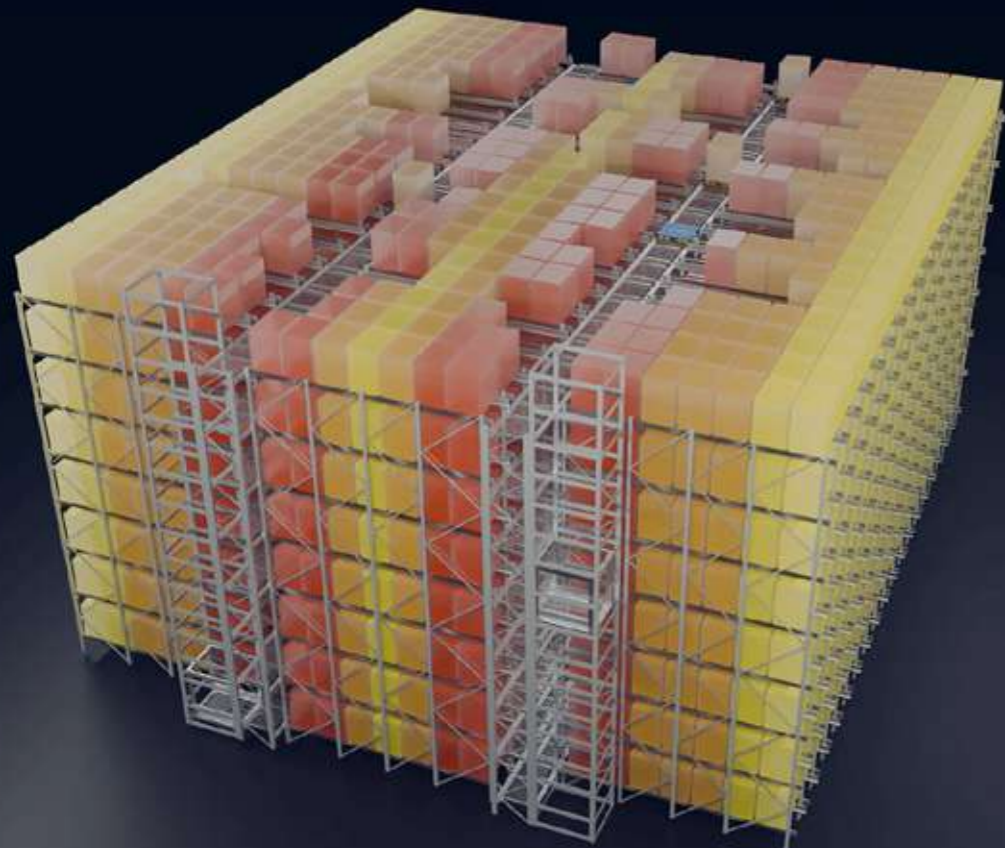

36

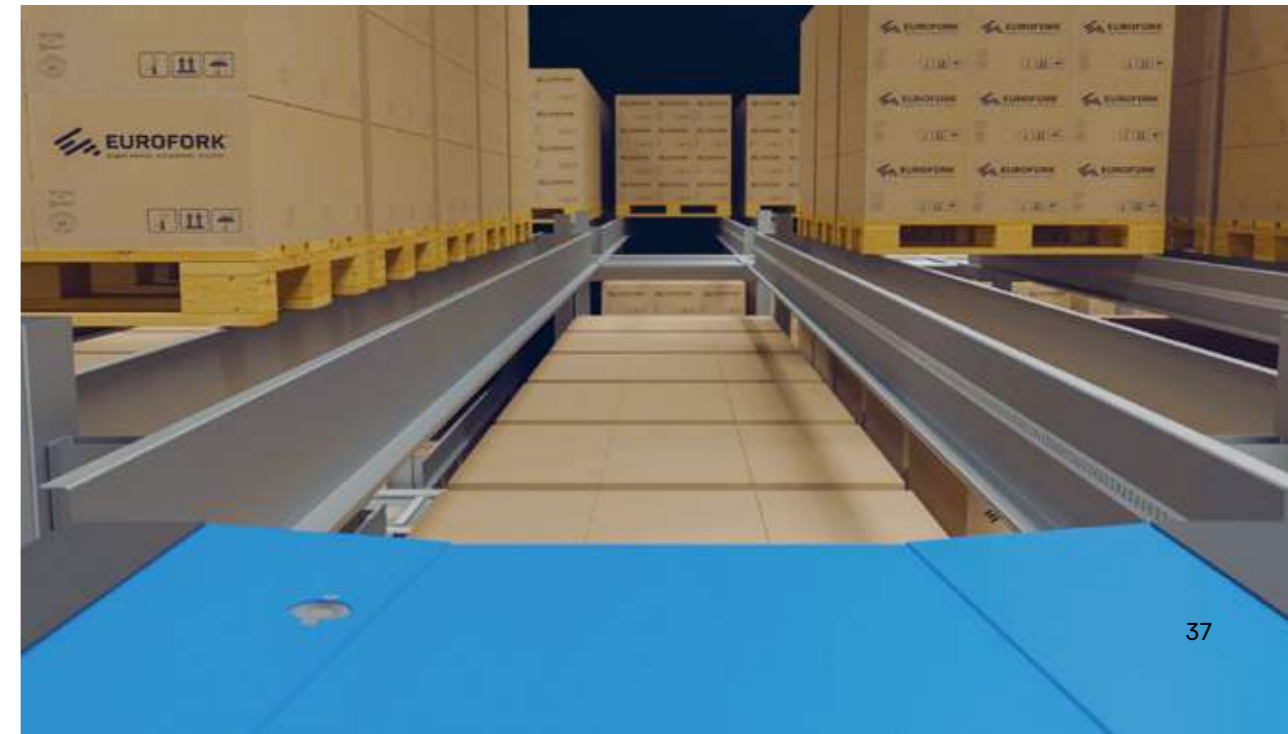

37

# CONDITION MONITORING

Through cutting-edge condition monitoring, onboard artificial intelligence (AI), and robust data analysis capabilities, E4SHUTTLE is more than just a storage solution—it's a performance optimizer. Stay ahead with real-time insights into system health, allowing proactive maintenance and minimizing downtime, by enhancing overall operational intelligence.

E4SHUTTLE is not just a system; it's your partner in efficiency, embracing the future of smart warehousing.

# ESMARTSHUTTLE®

ESMARTSHUTTLE®, composed of E-SHUTTLE (mother) and E-SATELLITE (child), is the pallet shuttle system designed for high-density, multi-reference storage in automated warehouses and production buffers where accurate and reliable 24/7 performance is required. Eurofork designed this smart solution according to the main customer's needs and requirements, offering the maximum warehouse capacity with high throughputs and performance.

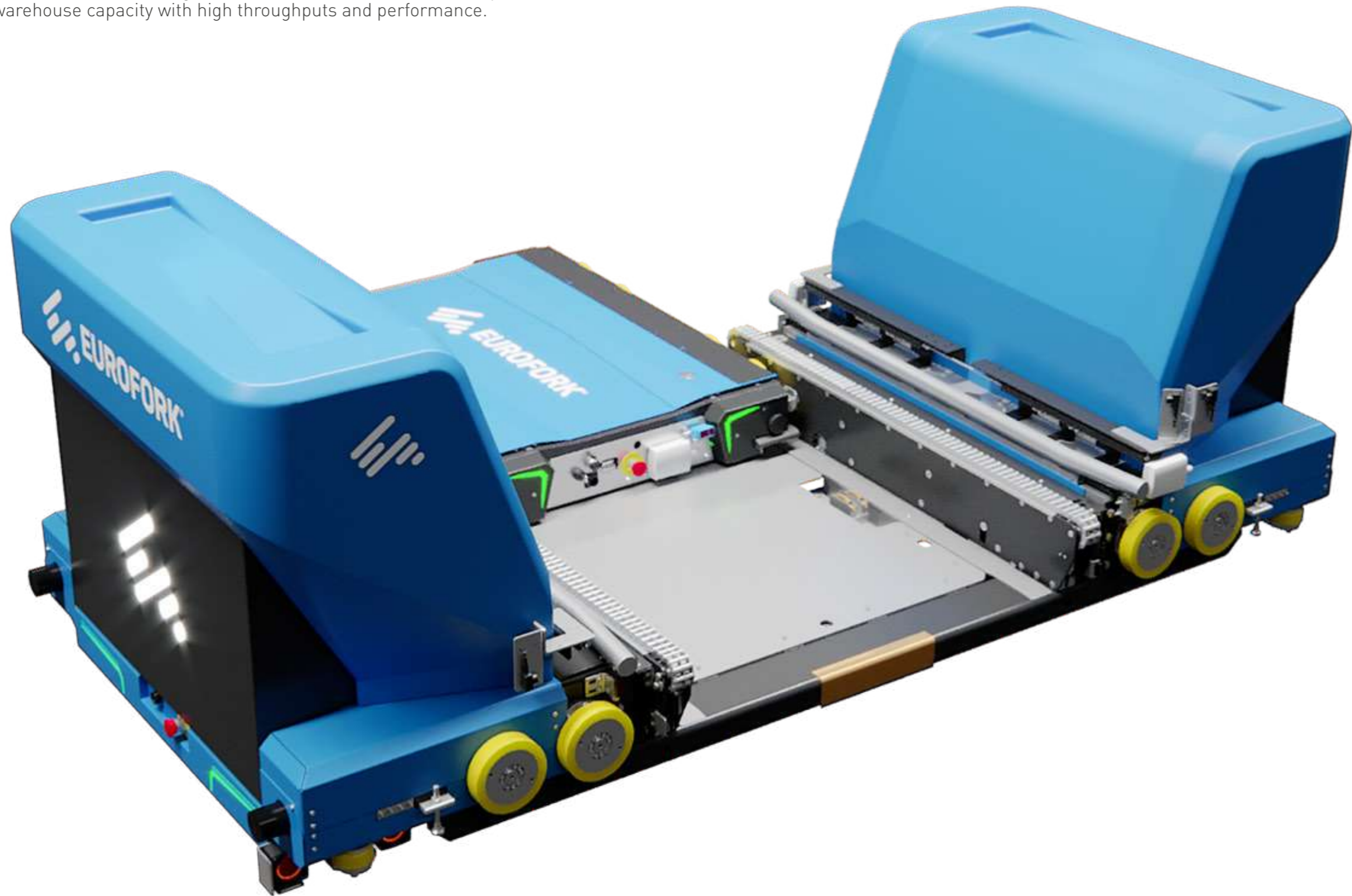

# HIGHLIGHTS

**FIT FOR YOUR WAREHOUSE**  
 Suitable and scalable for every type of building including freezer warehouses

**MASSIVE PERFORMANCES**  
 Multiple E-SATELLITE for each E-SHUTTLE and multiple ESMARTSHUTTLE® at the same level

**ABSOLUTE POSITIONING**  
 Thanks to Eurofork internationally patented solution

**ROAMING SHUTTLES**  
 To minimize the number of machines needed for low and medium throughputs

**CONDITION MONITORING**  
 AI on board and data analysis to improve efficiency

**VOLUME OPTIMIZATION**  
 Maximized pallets stored, regardless of their size

**REMOTE CONTROL**  
 24/7 wherever you are

**PARTIAL MISSIONS**  
 To ensure the total channel utilization

**NO DEAD TIMES**  
 Independent & simultaneous missions of E-Shuttle and E-Satellite

**ENERGY SAVING**  
 Up to -40% energy consumption compared to stacker-crane

**GUARANTEED SAFETY**  
 Patented system for safe access inside the warehouse

**BORN FOR HIGH-DENSITY**  
 Guaranteed by the experience and know-how of Eurofork

**GREAT SCALABILITY**  
 Flexible increase/removal of shuttles according to business needs

**WIDE TEMPERATURE RANGE**  
 Environments from -30°C up to +40°C (-22°F / 104°F)

**FIFO, LIFO, FEFO**  
 and any other logic

**BULKY LOADS**  
 Standard loads up to 2000kg (4400 lb)

**GREAT FLEXIBILITY**  
 To store every type of load

**SUPERIOR MULTI-DEPTH**  
 Up to 100 pallet locations per channel

**MULTIPLE CYCLES**  
 Up to 1600 double cycles/hour

**EXA**  
 Powered by EXA platform

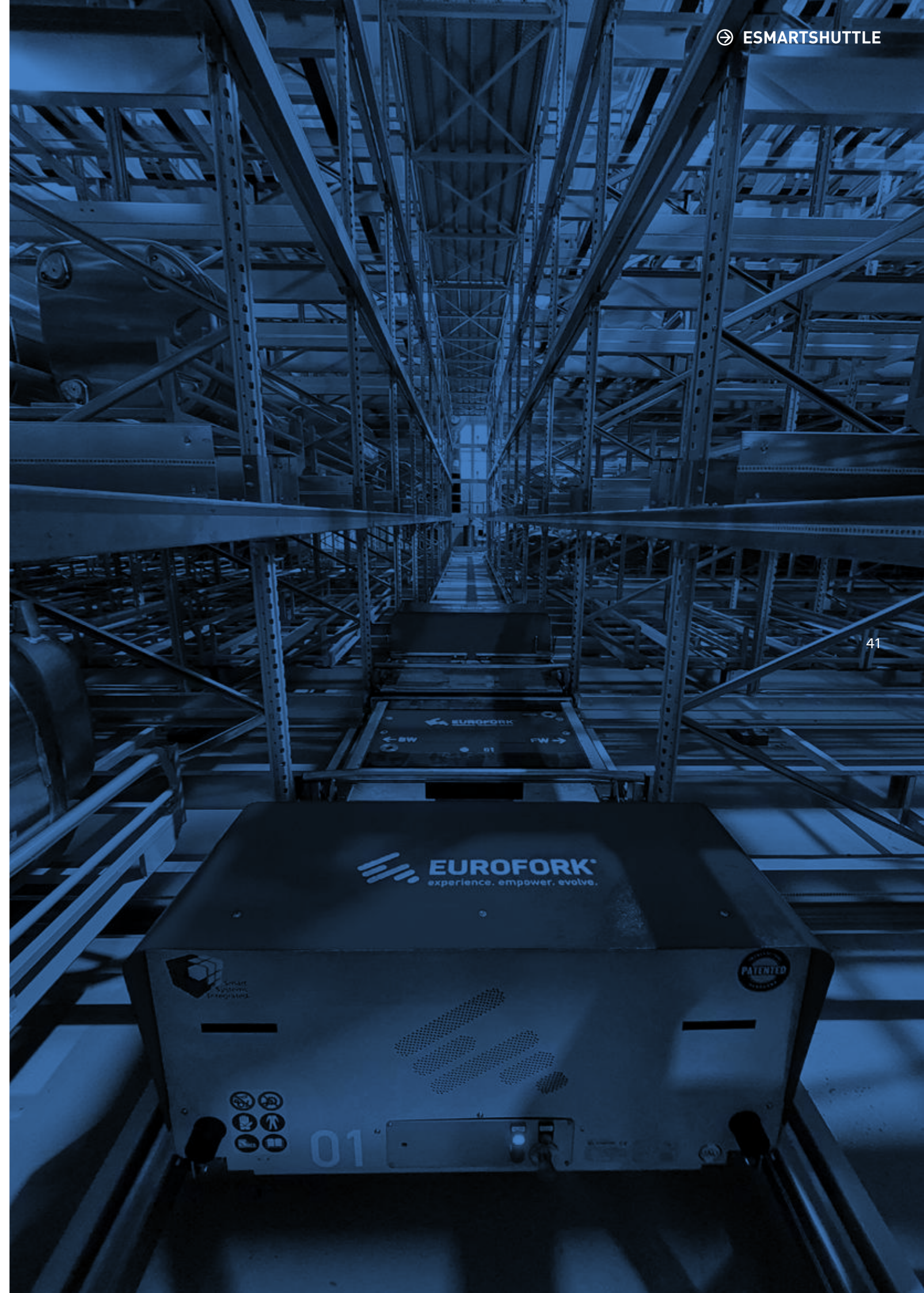

# WHY ESMARTSHUTTLE®

Thanks to its international patent on absolute positioning, ESMARTSHUTTLE® is able to accomplish independent missions, operate seamlessly with two machines in the same aisle, and precisely store pallets with unmatched accuracy and repeatability. This innovation enables unparalleled volume optimization, revolutionizing warehouse operations.

With more than 10 years of experience, ESMARTSHUTTLE® travelled 44 million kilometres (more than 1.000 globe turns!) and scanned 4,4 trillion QR codes of DataMatrix, making Eurofork's pallet shuttle systems a market-proven and future-proof solution.





# FLEXIBLE

ESMARTSHUTTLE® is designed to work either in critical thermal conditions, from -30°C up to +40°C (-22°F / 104°F), or with loads of different dimensions or heavier than the standard 1500 kg (3300 lb), up to 2000kg (4400 lb). It can work in automatic warehouses of any sector.

It can maximize available space, working in automated warehouses of all sizes and pre-existing buildings with height limits, structural impediments or irregular layouts.

Flexibility and modularity allow ESMARTSHUTTLE® to be fully scalable, optimising automation costs and maximising the performance of the entire warehouse.



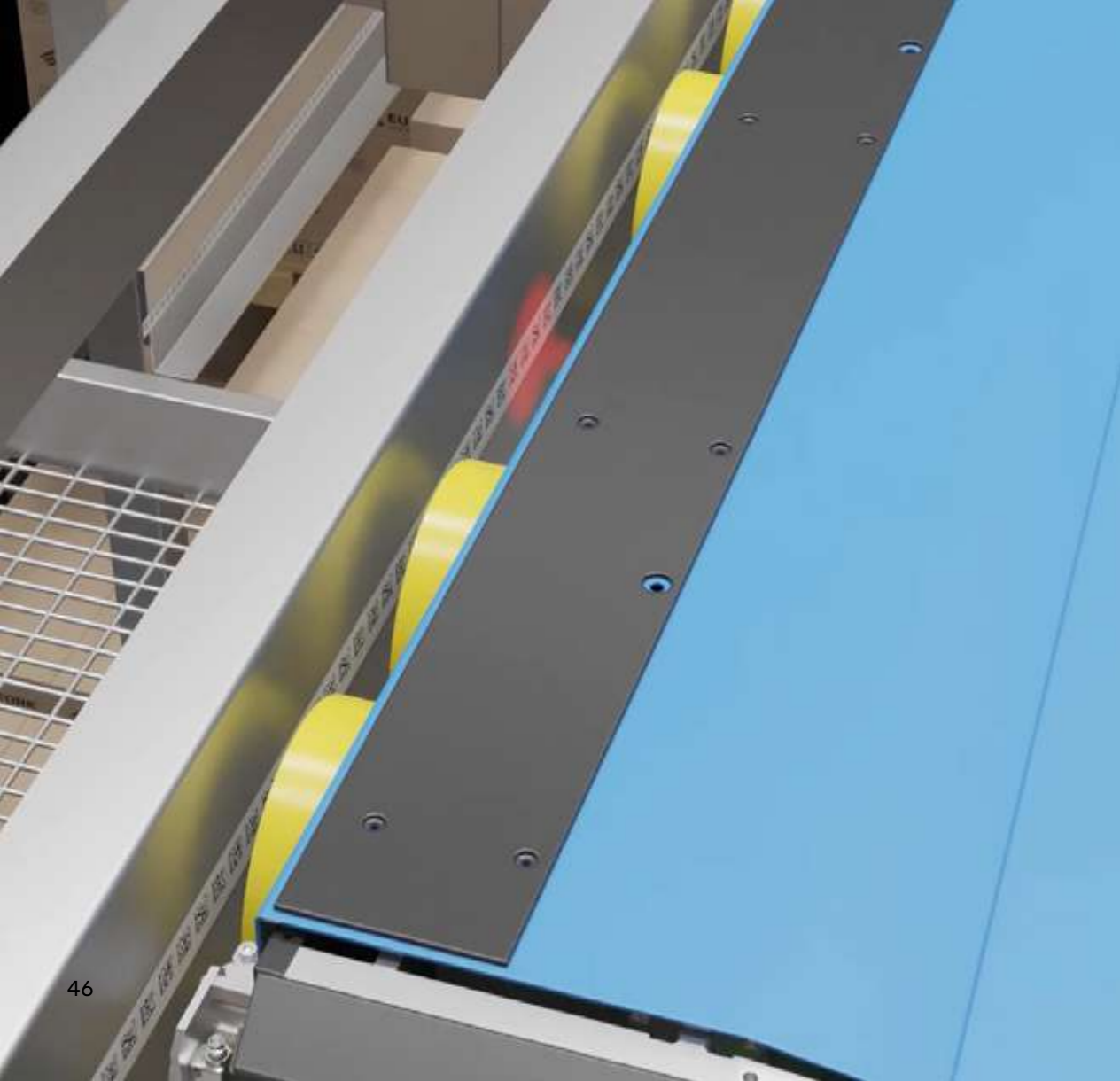

# INDEPENDENT MISSIONS

Thanks to the absolute positioning, ESMARTSHUTTLE® can also carry out independent missions maximizing the performance of the warehouse.

The two machines work at once: the E-SHUTTLE transfers the load in the aisle while the E-SATELLITE runs simultaneously in the channel.

**PATENTED**

# ABSOLUTE POSITIONING

Bolstered by its international patent, ESMARTSHUTTLE® guarantees the absolute positioning of the machines and the destination of the loads.

ESMARTSHUTTLE® 3D maps the entire warehouse, allowing the machines to move and store the goods with absolute precision, optimising the space in the channels thanks to compact pallet positioning and reaching up to 100 pallet locations per channel.

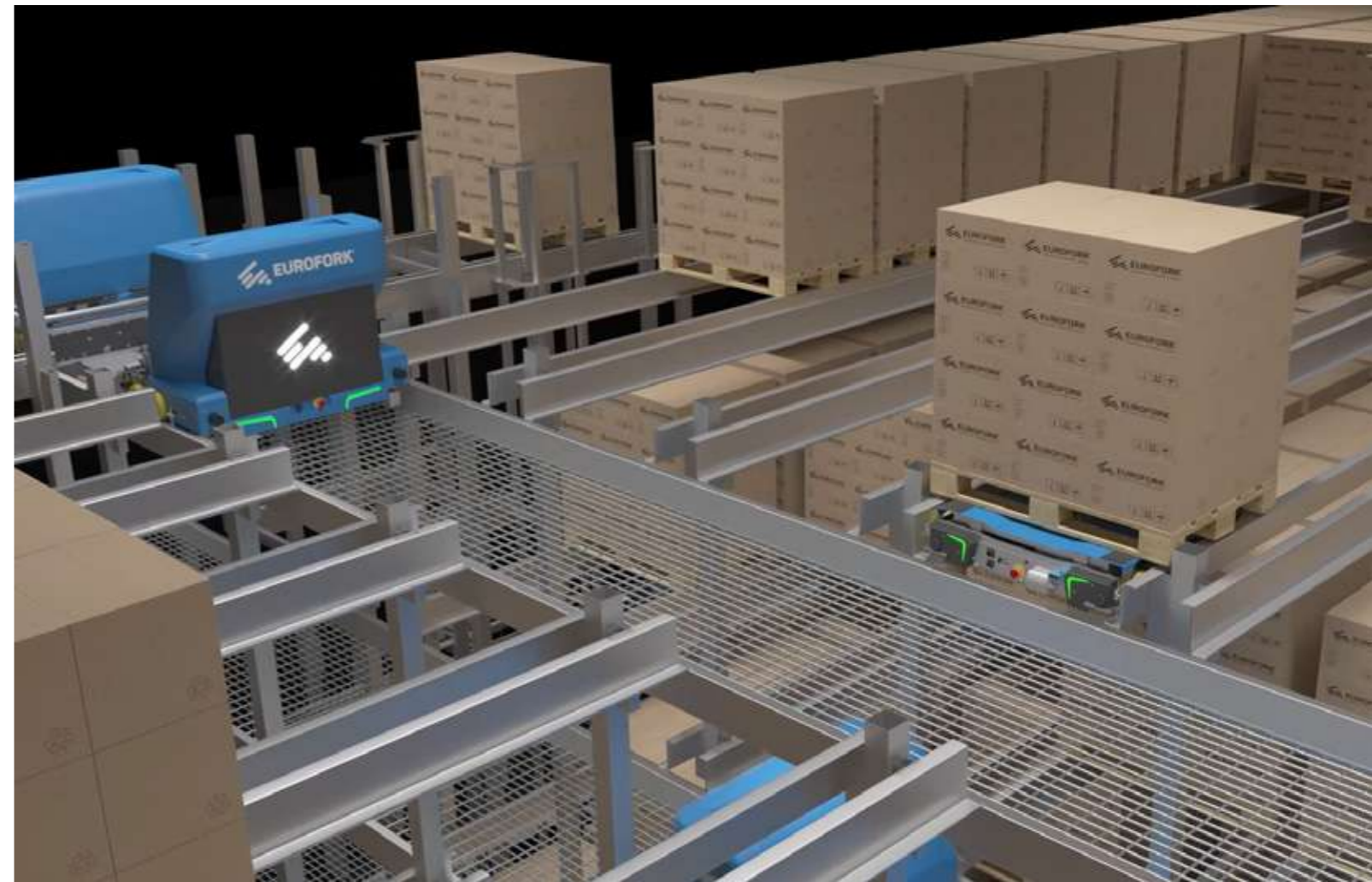

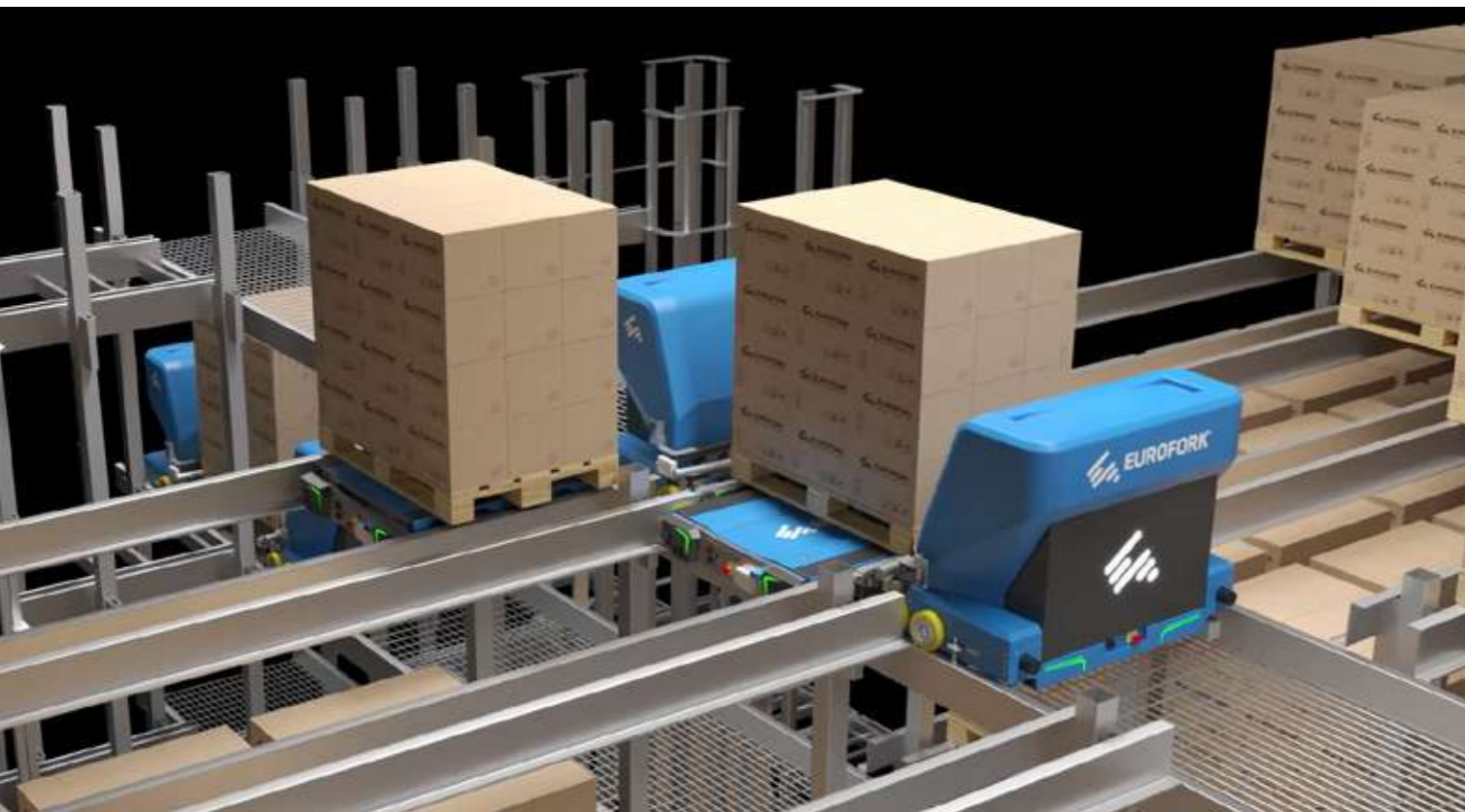

# MAXIMUM PERFORMANCE

The absolute positioning significantly increases the performance of the entire warehouse, among the others: two E-SATELLITES working with one E-SHUTTLE, independent missions and up to two E-SHUTTLE operating on the same aisle.

Thanks to these functionalities, ESMARTSHUTTLE® is the best solution to increase the performance of any automated warehouse. Moreover, the intense storage flow is accompanied by incredible volume optimization, then saving land costs and reducing vertical dimensions.



# NON-STOP WORKING

ESMARTSHUTTLE's dedicated system network guarantees a reliable, powerful and stable connection thanks to the 5Ghz Wi-Fi communication.

The satellite's latest-generation lithium battery, which recharges in masked time, allows ESMARTSHUTTLE® to take advantage of positioning with Datamatrix, confirming itself as the only pallet shuttle capable of regularly carrying out independent missions.

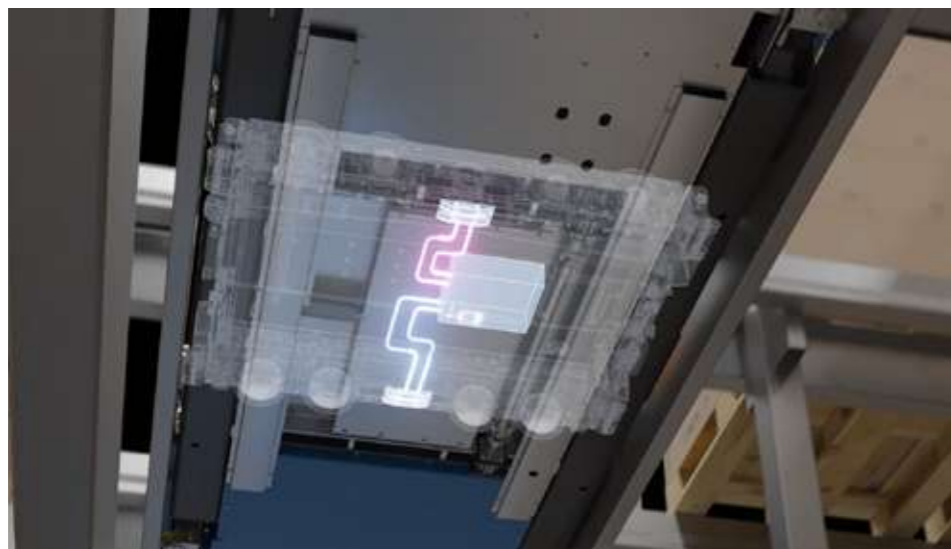

# MISSION UPDATE

The ESMARTSHUTTLE® system, integrated with EXA and PLC, can automatically detect any unexpected issue during pallet transport, such as a damaged or misaligned pallet. Upon detecting an anomaly, EXA and PLC promptly react to restore the mission. If the pallet still reaches its intended destination, a silent warning is saved to indicate the anomalous event.

In cases where the mission fails again due to the anomaly, the system is designed to block the affected channel and automatically redirect the pallet to a new destination. This process occurs without human intervention, ensuring smooth and uninterrupted operations.

Thanks to these advanced features, the ESMARTSHUTTLE® system provides dynamic and intelligent management of anomalies, minimizing downtime and optimizing overall warehouse productivity.

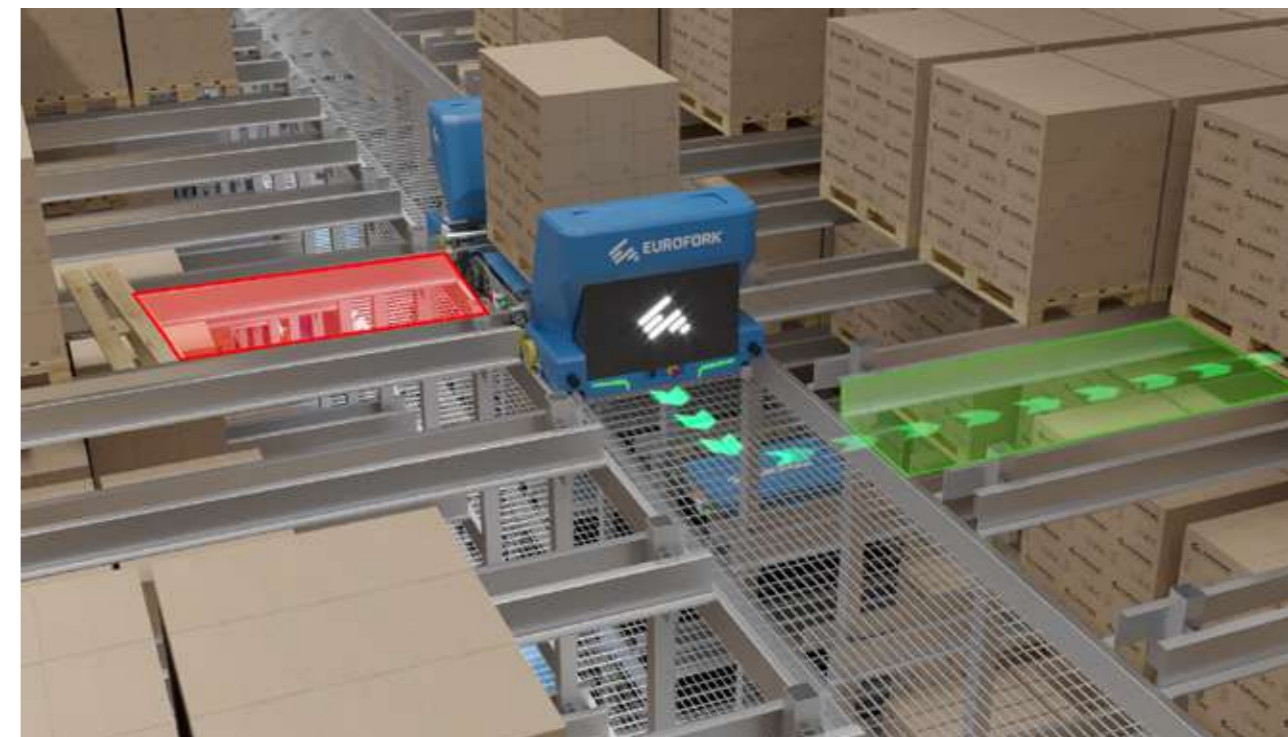

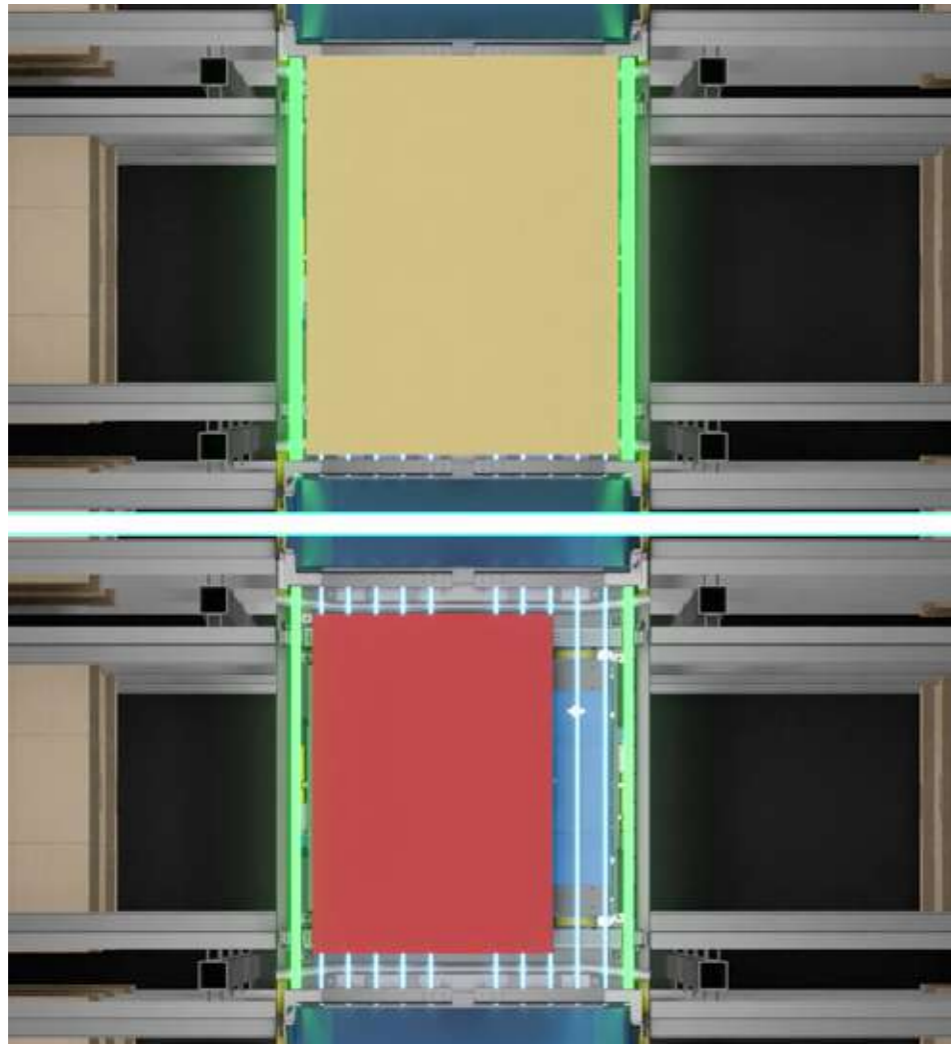

# FUTURE-PROOF SOLUTION

Pallets are dynamically positioned on chain conveyors according to their dimensions and overhang, ensuring optimal use of space and maintaining stability during transport. The system uses I/O link light barriers that are remotely adjustable, allowing it to accommodate the loads of tomorrow without the need for mechanical modifications or settings or physical settings on the machine.

This adaptability means that the system can manage varying load sizes seamlessly, maintaining a constant gap between different loads to ensure smooth and efficient handling. The mission is consistently accomplished, providing a reliable and flexible solution for modern warehousing needs.

# SMART & PREDICTIVE MAINTENANCE

Maintenance intervals are intelligently managed by calculating cycles, missions, and working time for each individual machine. This ensures that maintenance is performed precisely when needed, based on the actual usage and workload of each unit.

Automatic lubrication units are available as an option, further simplifying maintenance processes and extending the life of the machinery. The system also supports predictive maintenance, using data and analytics to anticipate potential issues before they become critical, allowing for proactive management of machine health.

Additionally, a real-time notification system and client pop-ups provide alerts for non-urgent maintenance actions. This keeps operators informed about necessary tasks without disrupting operations, ensuring that maintenance can be planned and executed efficiently.



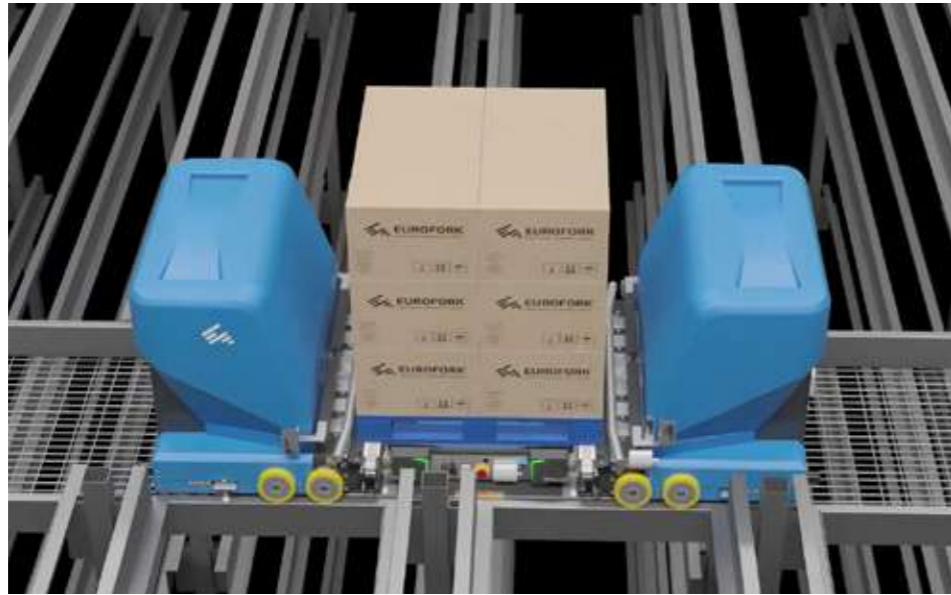

# LOAD FLEXIBILITY

ESMARTSHUTTLE® can handle loads for Food&Beverage, Automotive, Coils or any other type of application sector, inside of any kind of environment. Eurofork never set boundaries to the customization of the machines, to provide the best solution according to the customer needs.

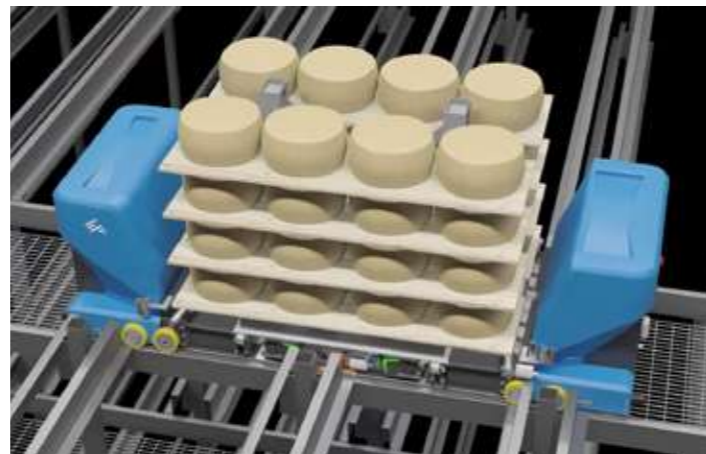

# EASY MAINTENANCE

ESMARTSHUTTLE® is a modular machine, so its maintenance is extremely easy: it is composed only of single components, that can be quickly replaced without even touching the others.

Eurofork offers a wide variety of service solutions to meet the specific needs for keeping your equipment operating at peak performance. The customer service department supports 24/7 the clients, remotely or with on-site interventions in short times thanks to the worldwide presence of the technicians. To guarantee an immediate and complete assistance service, Eurofork offers also automatic mailing and calling systems, to instantly advise the customer in case of problems.

The service team also carries out training courses for routine maintenance and provides analysis and maintenance to improve product efficiency.

# E-SMARTFORKS

Eurofork knows well that safeguarding proper working conditions is essential to maintain high performance in your warehouse and avoiding unexpected costs.

Eurofork has combined all its know-how in the field of automatic handling and technological development applied to its 4.0 shuttle systems to create the new evolution of telescopic forks: the E-SMARTFORKS.

Thanks to IoT devices and sensors from the best worldwide brands, E-SMARTFORKS not only allow you to monitor the status of telescopic forks in real time but also to predict any problems resulting from unexpected events not related to the forks.

In addition, all data can be analyzed, stored, and processed in the cloud without any interconnection with company MES and ERP systems.

Welcome to the future!

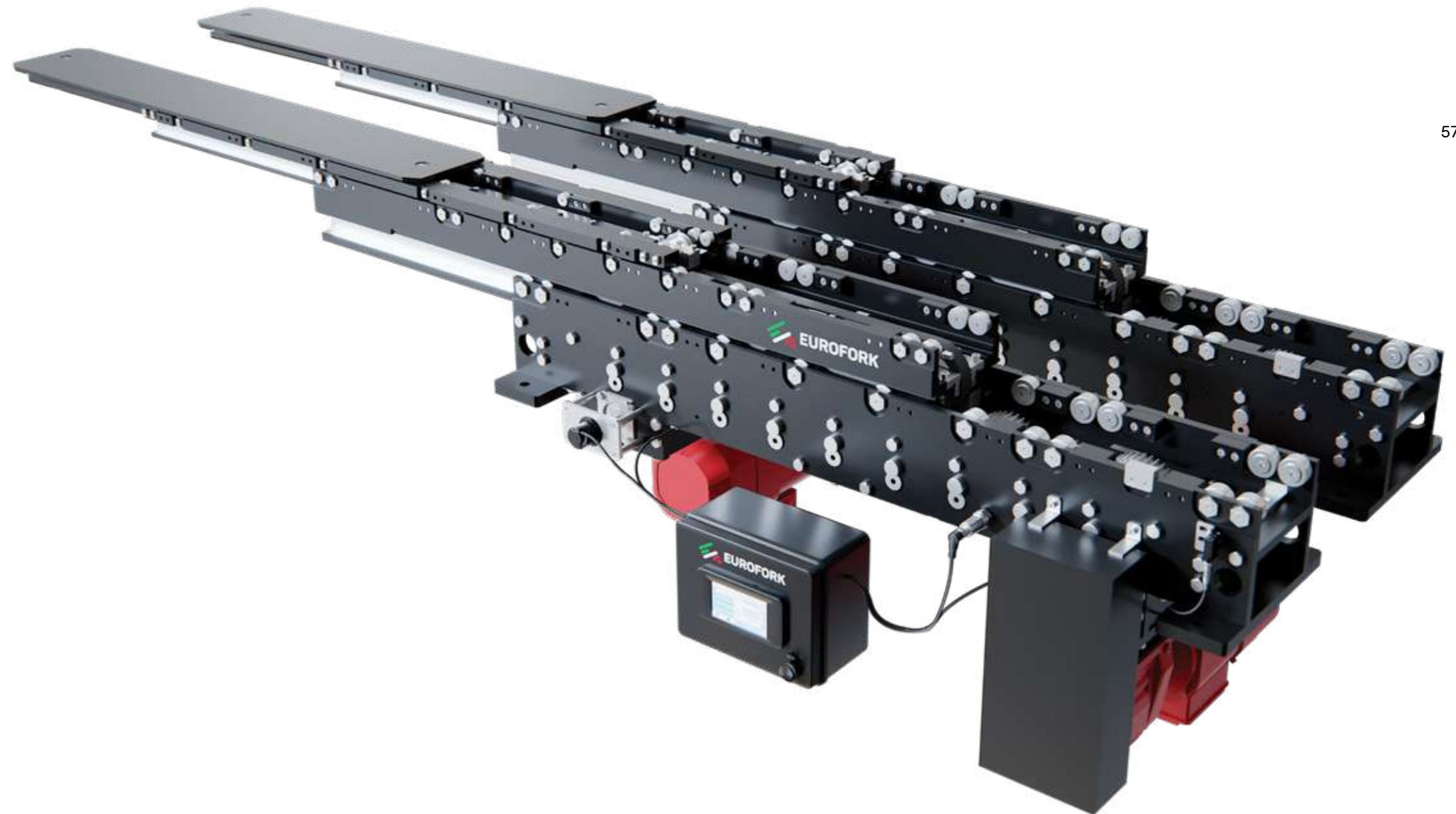

# HIGHLIGHTS



**INTEGRATION FLEXIBILITY**  
integrative level of solution aligned  
with customer requirements



**DOWNTIME RISK MITIGATION**  
enabled by continuous data analysis  
of the working conditions



**PREDICTIVE MAINTENANCE**  
maintenance times and frequency  
optimized thanks to data collecting



**HIGH-PERFORMANCE MONITORING**  
by leveraging the processing  
of indicators' outcome



**CLOUD BIG DATA**  
simple cloud connection and no interconnections  
with MES - ERP to let Eurofork process data

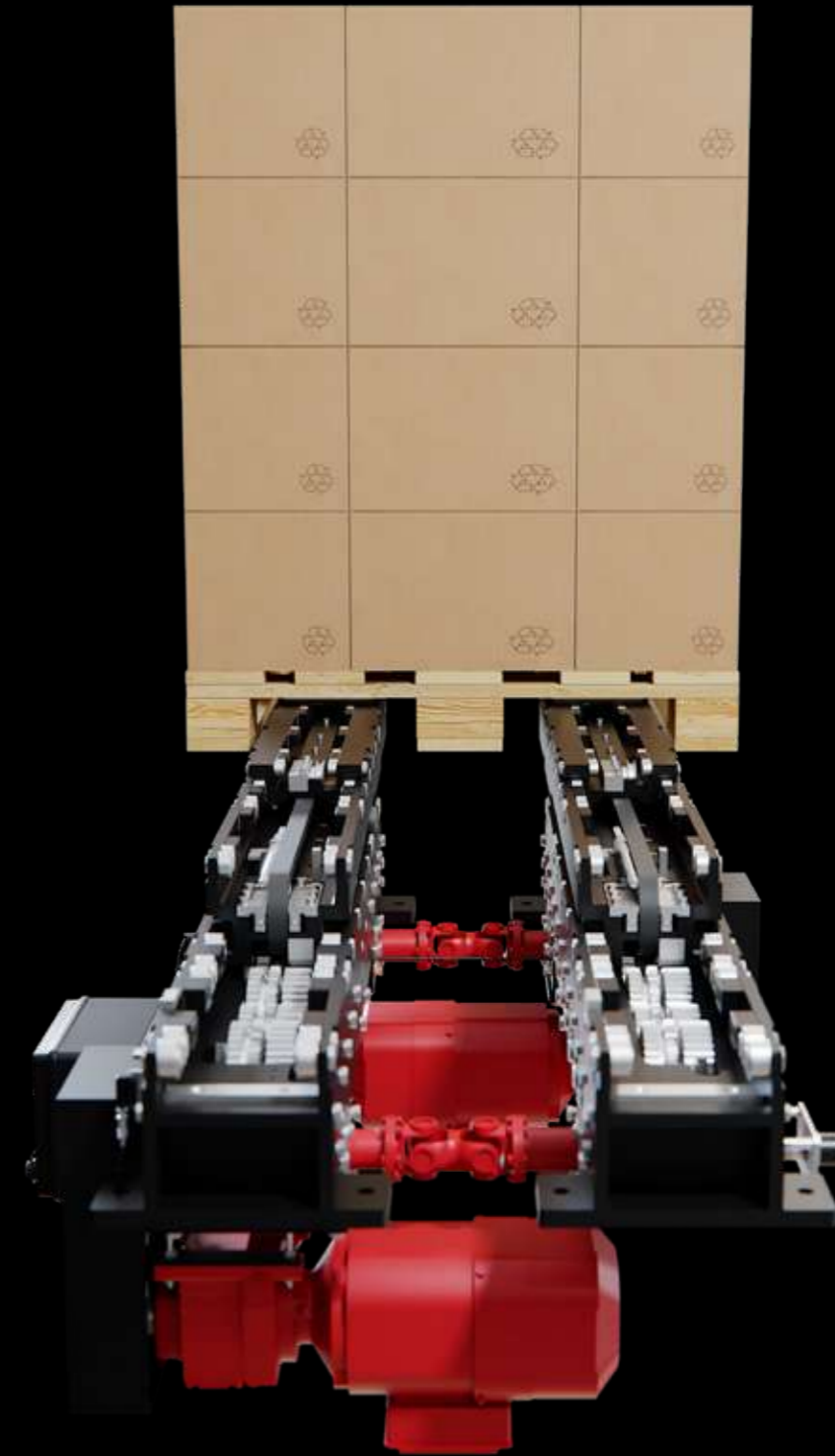



60

# WORKING ENVIRONMENT MONITORING

E-SMARTFORKS, equipped with an advanced continuous temperature monitoring sensor, ensures 24/7 safeguarding of component lifetime. Meticulously designed to endure extreme environmental challenges, each fork delivers reliable and enduring performance.

The integrated temperature monitoring system enables intelligent resource management, detecting variations promptly for preventive interventions. Choose safety and reliability with E-SMARTFORKS, revolutionizing maintenance practices for consistent performance over time.

# HIGH-PERFORMANCE INDICATORS

E-SMARTFORKS establishes a new benchmark, featuring cutting-edge attributes crafted to enhance overall performance and efficiency. The incorporation of high-performance indicators within E-SMARTFORKS guarantees unmatched accuracy and torque control management.

Whether negotiating challenging industrial settings or executing intricate tasks, E-SMARTFORKS ensures precision and reliability. Encounter advanced technology that revolutionizes material handling operations. With E-SMARTFORKS, a competitive edge is gained, delivering optimal results in accuracy and torque control for heightened productivity and operational excellence.”

61



# PREDICTIVE MAINTENANCE

E-SMARTFORKS emphasizes predictive maintenance, transforming the optimization of maintenance time and frequency through advanced data collection capabilities. This innovative feature tailors maintenance activities precisely to the specific needs of the equipment. Leveraging data-driven insights, E-SMARTFORKS minimizes downtime and enhances operational efficiency.

Experience a revolutionary solution that goes beyond conventional standards, offering a strategic approach to maintenance that maximizes equipment reliability and minimizes disruptions. With E-SMARTFORKS, anticipate the future of maintenance in material handling, where efficiency meets precision.



62



63

# DOWNTIME RISK MITIGATION

Downtime risk mitigation takes center stage with E-SMARTFORKS, driven by continuous data analysis of working conditions. E-SMARTFORKS employs advanced technology to analyze operational data in real-time, allowing for proactive measures to mitigate the risk of downtime. This innovative approach ensures that potential issues are identified and addressed before they impact productivity.

With E-SMARTFORKS, experience an automation solution that prioritizes uptime reliability, leveraging continuous data analysis to keep your operations running smoothly. Trust in a future-ready material handling solution where downtime risk is systematically minimized through intelligent and continuous monitoring.



64

# MACHINE LEARNING

E-SMARTFORKS showcases an advanced capability in data collection through machine learning, marking a significant leap in automatic handling technology.

Through cutting-edge machine learning algorithms, E-SMARTFORKS gathers valuable operational insights in real-time, allowing for a nuanced understanding of its environment.

What sets E-SMARTFORKS apart is its seamless data transmission capability, effortlessly sending pertinent information from the telescopic forks to the client. This streamlined process ensures that crucial data reaches the right hands promptly, enabling informed decision-making.

# CLOUD BIG DATA

E-SMARTFORKS introduces a revolutionary feature with automated alert notifications, enhancing its power in cloud big data solutions. Once the controller is installed, the system takes charge of monitoring and automatically sends email notifications for any activated warnings. This innovative functionality allows the system to proactively manage the forks. Moreover, the client can forget about manual oversight and rely on E-SMARTFORKS for timely and automated alerts, thereby enhancing operational efficiency.

Unlike traditional interconnections with Manufacturing Execution Systems (MES) or Enterprise Resource Planning (ERP), E-SMARTFORKS opts for a simple cloud architecture to facilitate agile and efficient data transfer. This approach ensures rapid access to actionable intelligence, seamlessly integrating machine learning, data transmission, and cloud big data. The result is unparalleled insights into material handling operations, empowering businesses with a sophisticated yet straightforward cloud solution.

65



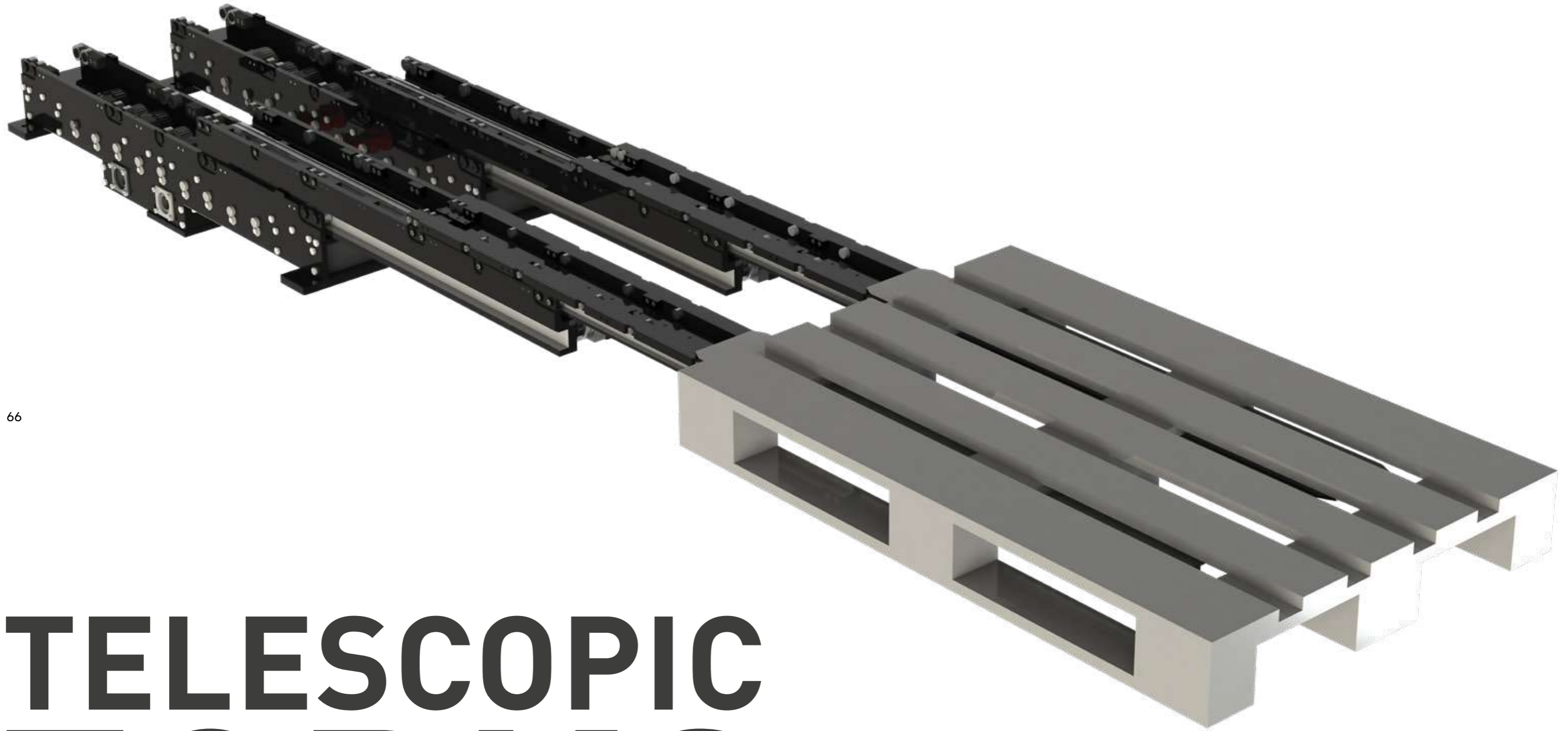

66

67

# TELESCOPIC FORKS

Designed to satisfy every need of system integrators, Eurofork's telescopic forks are produced entirely in Italy, using only components of the best Worldwide brands and certified materials.

# HIGHLIGHTS



**RELIABILITY**

Designed for best performances, handling heavy unit loads with low deflections



**STURDINESS**

Made with certified material, equipped with components from primary European brands



**EFFICIENCY**

High level of performance, precision and stability over time



**ABSOLUTE QUALITY**

Covered by international patents



**MADE IN ITALY**

Produced and tested entirely in Italy



**MAINTENANCE INSPECTION**

Easy maintenance checks for optimal performance



**DYNAMIC TESTING**

Subjected to specific internal and functional tests before delivery



**CUSTOMIZATION**

Designed to meet all kinds of customer needs in any application sector



**FLEXIBILITY**

Designed to stock keeping units of any weight and size



**DELIVERY TIME**

Fast delivery around the world



**INNOVATION**

Non-stop development



**DATA INTEGRATION**

Data collection for enhanced efficiency





70

# PALLET

Pallet line forks have been developed to handle any type of pallet inside an automatic warehouse.

Simple, double or triple deep, Eurofork's telescopic forks have always offered a total guarantee of reliability in any sector of application.

## HIGHLIGHTS

- Small size and absolute positioning precision
- Reduced deflection value
- High reliability and easy maintenance
- Working temperature up to -30° C (- 22° F)
- Fully customizable

71



### SINGLE DEEP

Among the most popular in automatic handling in warehouses with stacker cranes. Versatile. Compact. Composed of a fixed body and two mobile elements, single deep telescopic forks manage all stock keeping units (SKU) handling in single deep racks

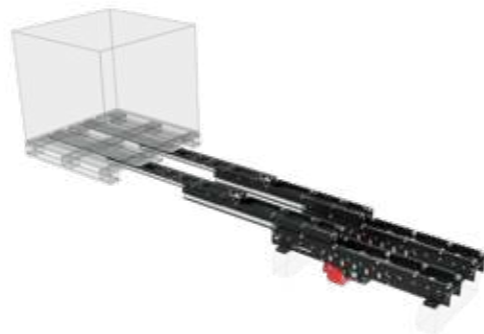

### DOUBLE DEEP

Consisting of a fixed body and three mobile elements to move the stock keeping units (SKU) bilaterally up to double deep racks. The transmission of the double deep telescopic forks simultaneously transfers the motion to all the elements.

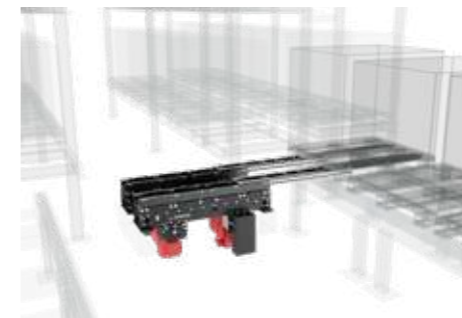

### DOUBLE DEEP - VARIANT VERSION

The variant version allows for decisive savings in the structural warehouse costs. The use of transmissions dedicated to the separate and more dynamic management of the slides makes it possible to easily store & retrieve both simple and double deep stock-keeping units, reducing the height of the moving parts.

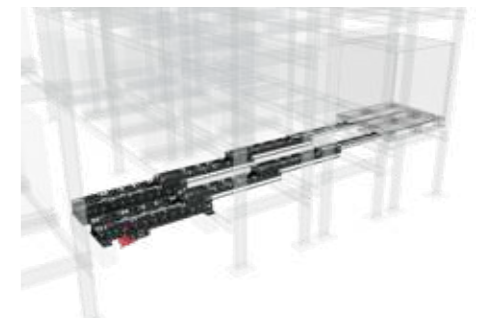

### TRIPLE DEEP

Triple deep forks allow to maximise available space and optimise automation costs, bilaterally storing and retrieving up to triple deep goods in automatic warehouses.

# AUTOMOTIVE

Used by the most important car manufacturers in the world, the Eurofork Automotive line telescopic forks perfectly mitigate the stresses deriving from the handling of vehicle bodies thanks to a fully geared transmission and the use of special components.

The strong propensity for innovation and experience in the field has allowed Eurofork to develop a specific telescopic forks line, designed to handle every kind of electric vehicle's batteries.

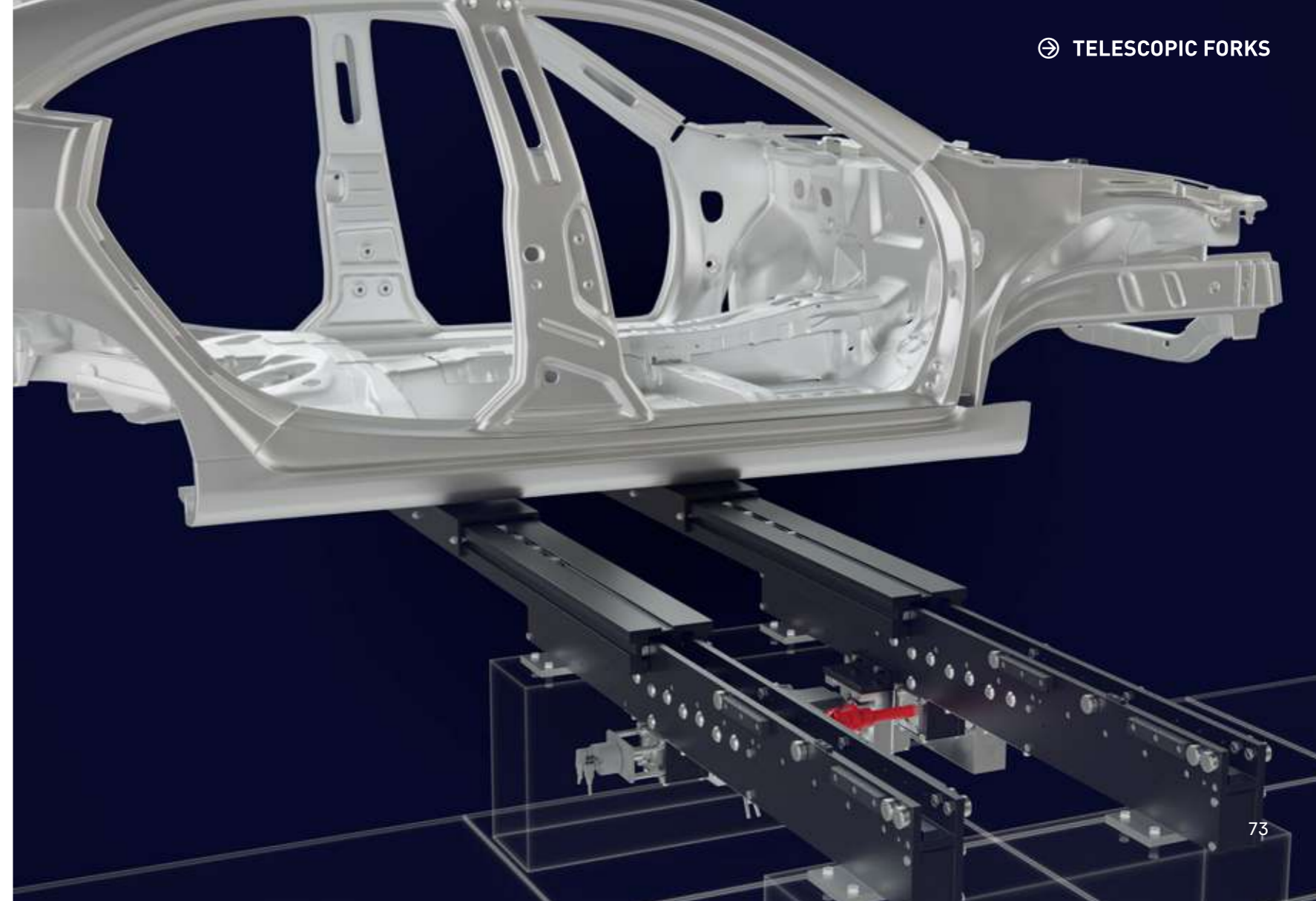

72

73

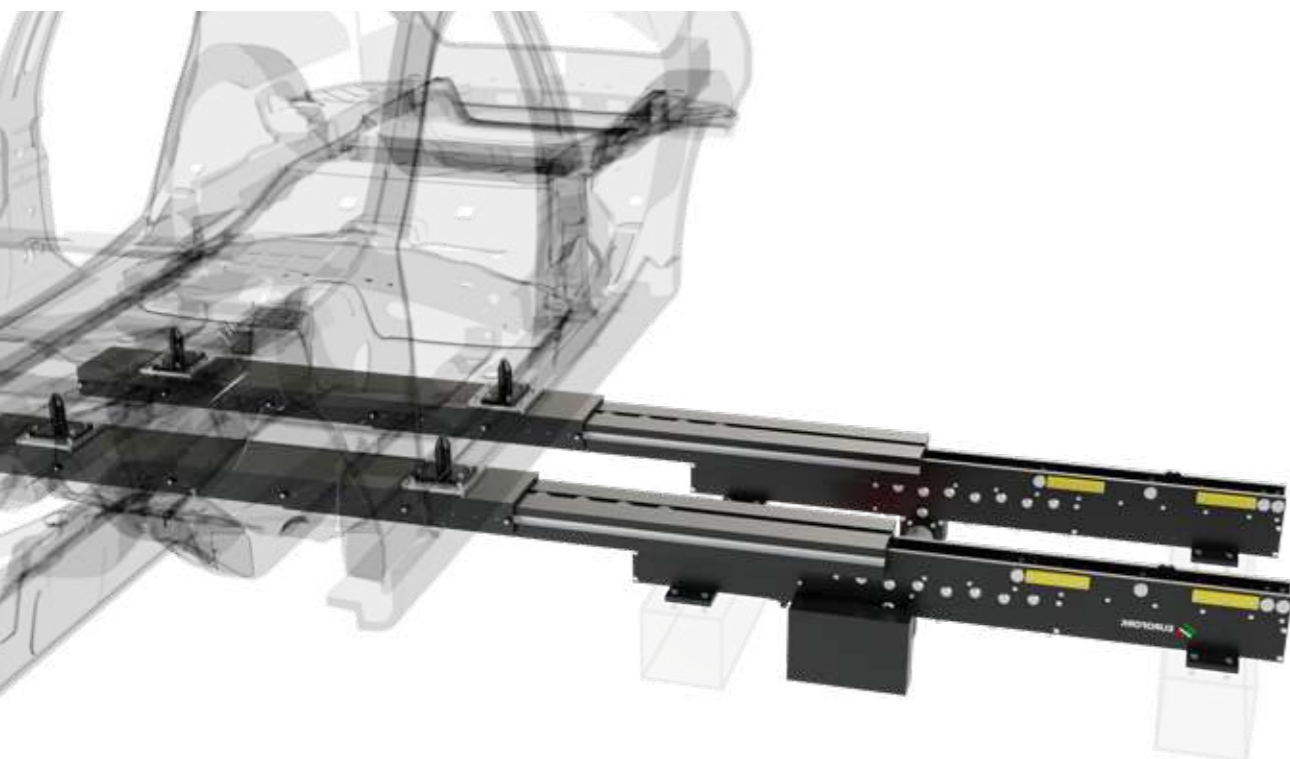

## HIGHLIGHTS

- Fully geared transmission
- High reliability and easy maintenance
- Fully customizable



# COILS

This type of telescopic fork is suitable for handling coils of any diameter and material such as textiles, paper and metal.

Eurofork customises each handling device according to the type of cargo storage with particular supports applied on the upper element or with an inclination of the entire device, to optimise the contact surface and allow a better distribution of stresses while keeping the load stable.



74

75

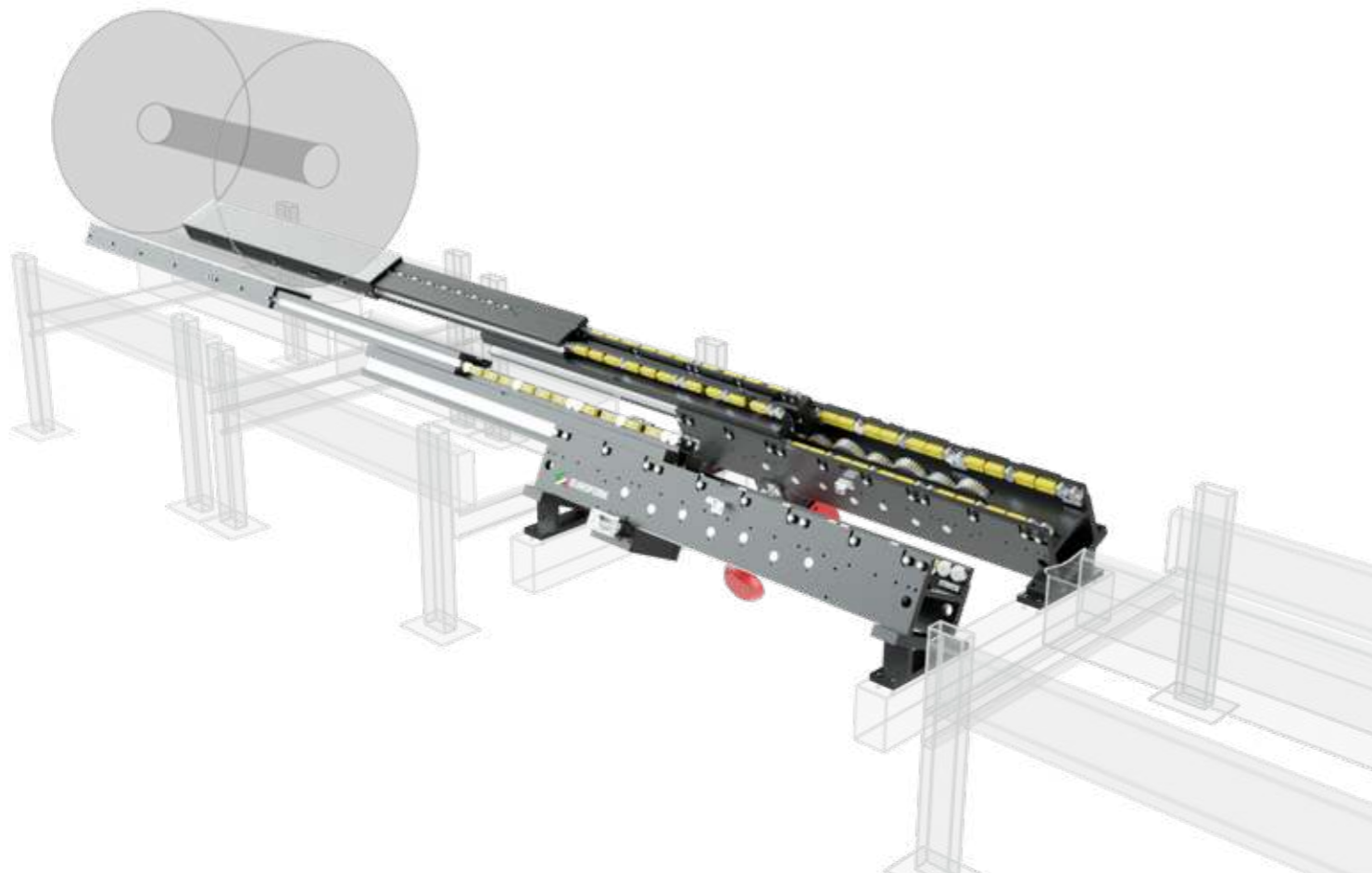

## HIGHLIGHTS

- Small size and absolute positioning precision
- Reduced deflection value
- High reliability and easy maintenance
- Working temperature up to -30° C (- 22° F)
- Fully customizable

# BOXES

It is increasingly necessary to build automatic warehouses for handling small loads such as cardboard or plastic boxes. Eurofork has combined the needs of the market by designing a line of solutions specifically for the fast and reliable handling of boxes.



## E-BOX GRIPPER

Speed, innovation and performance in a single solution. Eurofork's technical team has exploited all its mechatronic experience to develop E-BOX GRIPPER, the innovative solution for the storage & retrieval of cardboard or plastic boxes.

Extremely compact, equipped with latest generation components and easy to configure and maintain, E-BOX GRIPPER is the ideal handling device for boxes in any sector.

### HIGHLIGHTS

- Available with variable fork to fork distance system
- Available with belt conveyor system
- Compact design and optimised weight
- Absolute positioning precision
- Speed in cycle-times
- Easy maintenance
- Fully customizable
- Rugged solution

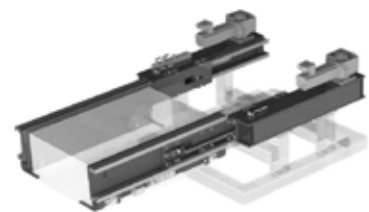

### E-BOX GRIPPER S

Designed for automatic warehouses that need higher throughput, E-BOX GRIPPER S can handle one carton or plastic box.



### E-BOX GRIPPER D

Designed for automatic warehouses that need higher throughput, E-BOX GRIPPER D can handle up to two boxes simultaneously.

## MINILOADS

Used with great results in many sectors such as e-commerce, the miniload line is versatile, agile and silent in handling carton or plastic boxes.

To optimise efficiency concerning particular warehouse layouts and types of load, they are usually combined with the belt conveyor systems.

### HIGHLIGHTS

- Compact design and optimised weight
- Absolute positioning precision
- Reduced deflection value
- Speed in cycle-times
- Any application (Cold, humidity, food...)
- Fully customizable



### MINILOAD S

Extremely versatile and silent in handling, the Miniload SD forks are perfect for handling small single deep stock keeping units. Lightweight and compact, they can be customised according to the application.

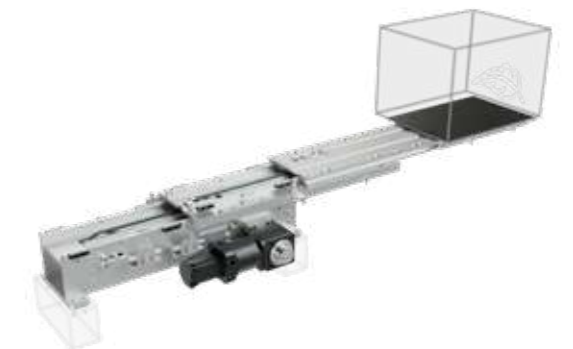

### MINILOAD D

Extremely versatile and silent in handling, the Miniload DD is capable of handling double deep stock keeping units with extreme speed. Compact and lightweight, they can be customised according to the application.

# ADDITIONS

When a particular way to handle the SKU is required, telescopic forks can be equipped with special additions, designed and tailored according to the customer's needs. Every system is aimed at getting more versatile handling device systems.

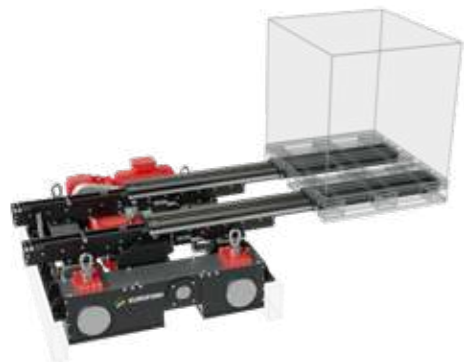

## LIFT SYSTEM

In the cases in which stacker-crane is not required, it is still necessary to lift loads. Eurofork's lifting systems integrated on shuttles, AGVs, LGVs or other systems without their lifting device, allow for the release and autonomous management of the load itself. Each lift system is designed and developed based on the size of the loads to be transported.



## CHAIN SYSTEM

This system is used for the centring or the variation of the position of the storage units in multi-deep. In addition, it can interface with customer loading bays. The chain system integrated allows moving the load from one fork side to the other. This system is used for heavier loads that can't be moved with belt system.



## BELT SYSTEM

The belt systems integrated into the telescopic forks allow for independent load handling, optimising SKU management time. Specifically, they are used for SKY pick/place in inbound and outbound bays to significantly reduce cycle times. These systems are mainly used in Miniload projects.



## VARIABLE FORK TO FORK DISTANCE

Ideal for warehouses where it is necessary to move different types of SKU, the systems with variable fork to fork distance allow you to manage different loads width, with just one device. It also can safely handle each load. By adapting the structure of our telescopic forks, they can be integrated with a variable fork to fork distance system, thus improving system performance and flexibility.

# SPECIAL APPLICATIONS

Telescopic forks for extremely humid environments and excessively low or high temperatures.

Handling of heavy loads or multiple pallets simultaneously with minimal deflections. Quadruple deep operations. These are just some of the possible applications thanks to Eurofork's know-how in the sector and R&D activity.

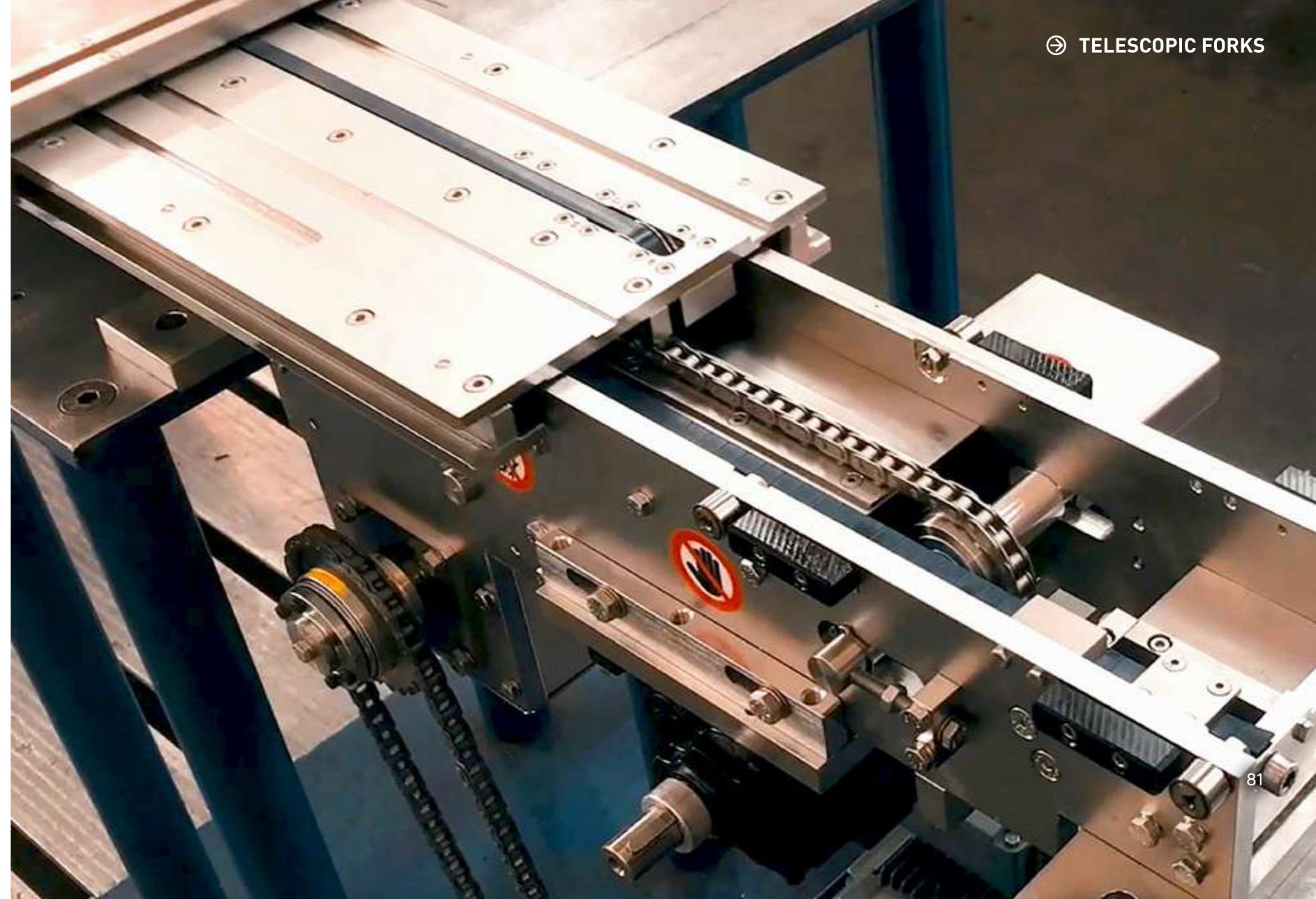

## MULTIPLE FORKS

When a couple of telescopic forks is not enough, Eurofork can combine multiple forks. This solution can solve different issues, such as very large/heavy loads, or when several support points are required.



## HIGHLIGHTS

- Reliability and sturdiness
- Modulability according to the load dimensions
- Scalability according to the unit load weight and size
- Fully customizable

## SPECIAL ENVIRONMENTS

Every telescopic fork can be equipped with special materials, according to the customer's needs. Frozen or very warm conditions, wet loads or extremely humid ambients, these forks are designed to support every kind of environment.

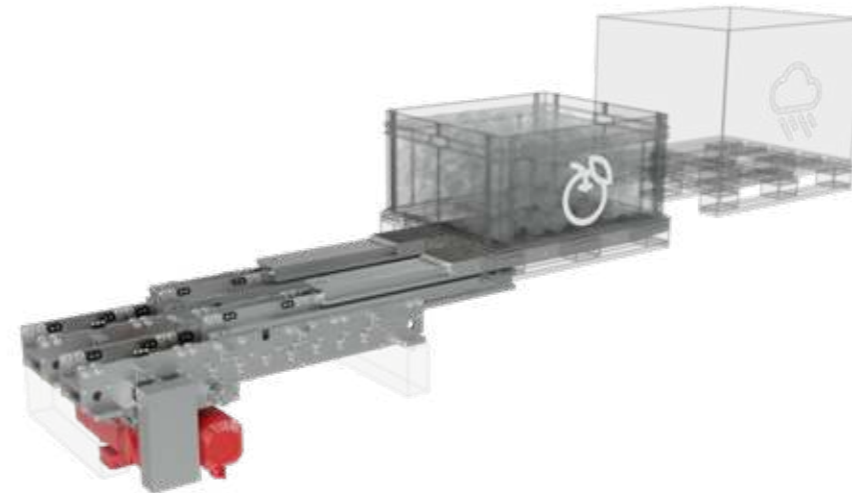

## HIGHLIGHTS

- Reliability and sturdiness
- Minimum deflection value
- Extreme environmental conditions
- Fully customizable

# AFTER-SALES

Today, it is essential for companies to be 100% efficient.

To safeguard the total functioning of the customers' devices, Eurofork has designed a network of highly qualified technicians ready to assist wherever the solutions are, at any time.

Service, spare parts, maintenance, retrofitting, revamping and more at the clients' disposal, 24/7.

This is Eurofork after-sales Team.



# REPAIRS & SPARE PARTS

All handling devices, even if made by other manufacturers, can be accurately repaired by the Eurofork after-sales team, composed of more than thirty qualified technicians.

All the operations include the shipment and possible installation of spare parts to maintain high performance, extend working life and prevent any problem in the device.

84

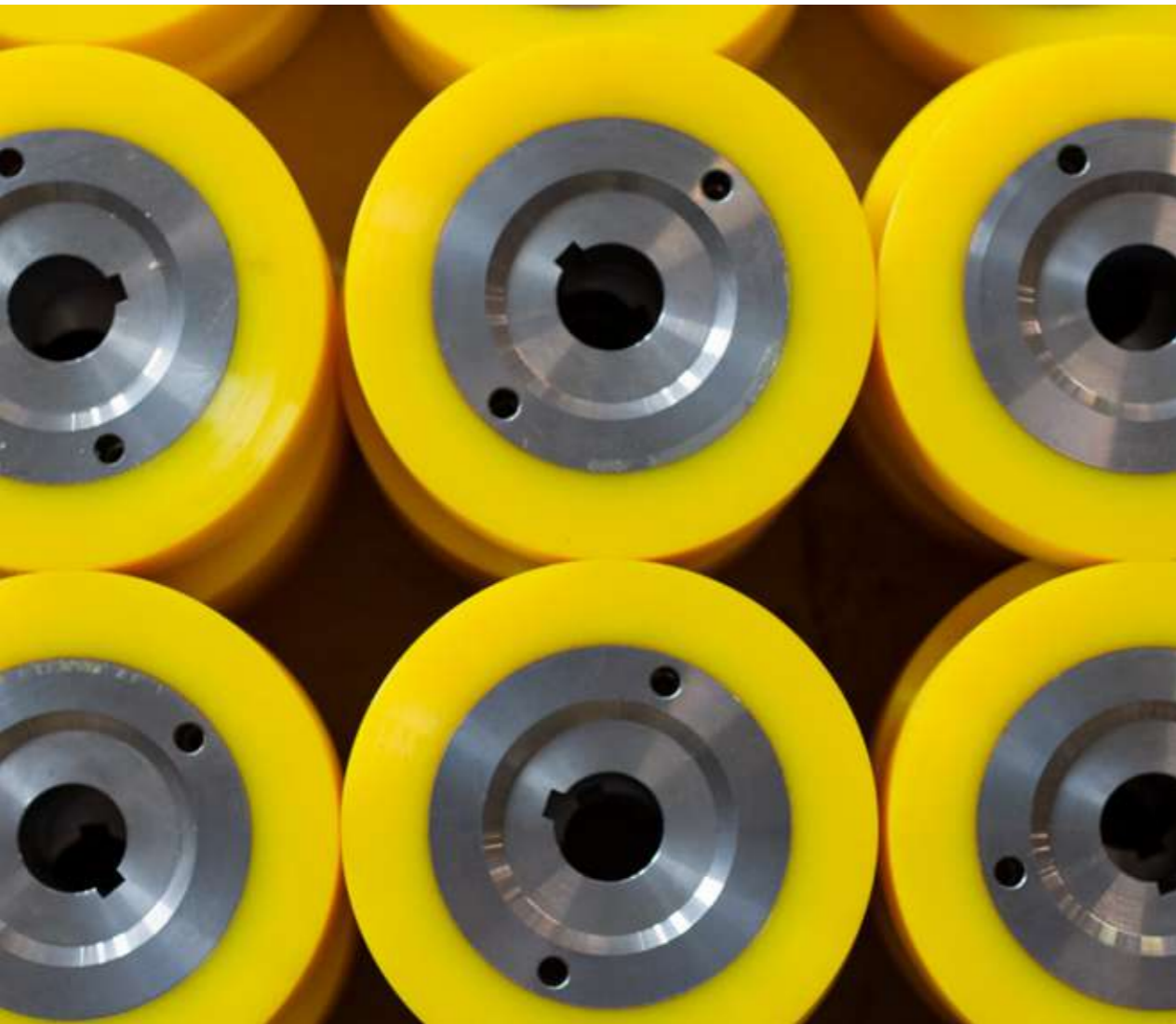

85

# TRAINING & MANUALS

Eurofork believes in sharing its wealth of experience with its customers.

The team organizes training courses on request to explain in detail the use and maintenance of the systems, also providing certificates.

Technical manuals are also available to ensure completely independent daily activities, from the installation of handling to the management and software configuration systems.

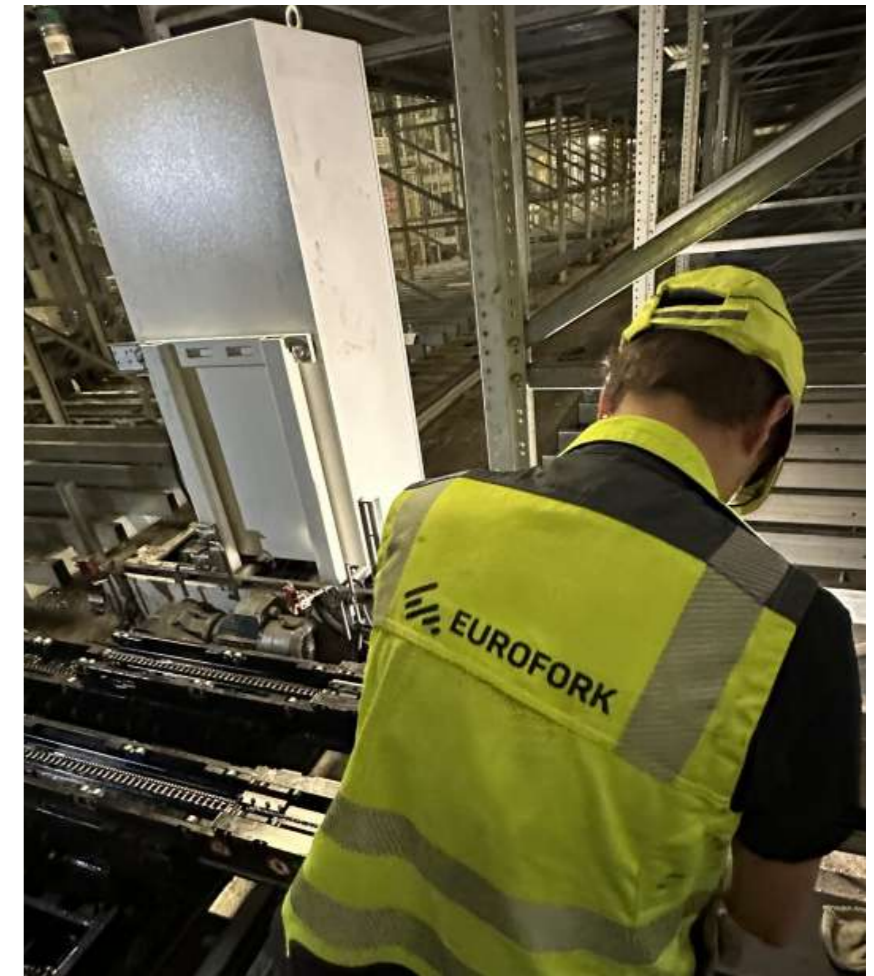

# ON-SITE & REMOTE ASSISTANCE

Customers first: this is Eurofork's mindset. To provide customers with fast and careful service, Eurofork experts guarantee immediate assistance all over the world 24/7.

Eurofork is constantly available to support customers with direct on-site interventions or remote assistance.



# RETROFITTING & REVAMPING

Over 20 years of experience in automatic handling devices allow Eurofork to know how to revamp and retrofit all types of devices, giving them a new and long-running life.

It doesn't matter if the handling devices are made by other manufacturers: Eurofork applies retrofit and revamping services on all devices.

# MAINTENANCE

Eurofork sets accurate plans of scheduled maintenance with the customers, based on a careful analysis of the product and taking into account available predictive maintenance tools.

No matter how exact maintenance scheduling is, external variables can always create inefficiencies. That's why Eurofork's team is active 365 days a year, either remotely or on-site, to carry out extraordinary maintenance operations wherever the device is.





experience. empower. evolve.

Eurofork's products are completely designed, manufactured and tested in Italy. They are installed and serviced by a network of qualified partners. Find out your local contact, videos and more information on the web page.

Eurofork® 2025 - All rights reserved

[www.eurofork.com](http://www.eurofork.com)

